

Parks and Recreation
Master Plan
2012 - 2017



CITY COUNCIL

James Dyer – Mayor
Wayne Booton – Council Member Ward 1
Nick Metzger – Council Member Ward 2
Brent Williams – Council Member Ward 3
Jack Reed – Council Member Ward 4
Jody Mankerian – Council Member Ward 5
Kathy Miller – Council Member At-Large

PLANNING COMMISSION

Susan Collins - Chair
Matt Davis – Vice Chair
Ken Oates
Tim Banfield
Julie Burke-Smith
David Revore
John Fleming
Keith Mengel

PARKS, RECREATION, and CEMETERY ADVISORY BOARD

Dave Phaner - Chair
Randy Eshuis
Mark Gilbert
Mitchell McComb
Lee Sherman
Kristine Boley-Morse
Lisa Sands

BROOKS NATURE AREA ADVISORY BOARD

Dave Phaner – Chair
Janet Schoenmeyer
Vicki Knickerbocker
Patty Hoch- Melluish
James Coury
Randy Eshuis

CITY STAFF

Tom Tarkiewicz - City Manager
Carl Fedders – Director of Public Services
Natalie Huestis – Director of Community Services
Teri Trudeau - Recreation Superintendent
Cheryl Vosburg – Environmental Coordinator

Table of Contents

Introduction	3
Community Description	3
Administrative Structure	3
Recreational Inventory	4
Description of Planning Process and Public Input Process.....	9
Goals and Objectives	10
Action Plan	10
Appendix A – 2010 Census Data	13
Appendix B – Organizational Chart	14
Appendix C – Parks Budget.....	15
Appendix D – Recreation Budget	16
Appendix E – Capital Improvement Plan.....	17
Appendix F – Great Lakes to Lakes Letter of Support	18
Appendix G – Parks Map	19
Appendix H – DNR Grant Inventory	22
Appendix I – Survey Results	25
Appendix J – Resolution	36

Introduction

The City of Marshall is pleased to present the 2012-2017 Parks and Recreation Master Plan. Due to funding reductions and current economic climate in the state, staff has taken on the duties of drafting this document. To gather information regarding programming and park development, the City of Marshall utilized the online services of Survey Monkey along with providing an opportunity for those that did not have internet access to voice their opinion. The plan represents the best interpretation of the desires of the clients being served. The City of Marshall has continued to foster a community of participation that has attracted tourist and residents to the area. The plan, that is contained here, provides a road map that staff and elected officials will use to guide these services for the next five years.

Community Description

The City of Marshall was established in 1830 with the hopes of becoming the state capitol. Although this never came to fruition, the City of Marshall has been able to retain a large portion of their history through the Historic Landmark District. Today, the City of Marshall offers a diverse mix of facilities and programs through the Parks and Recreation Departments that lead to a higher standard of living compared to other communities.

The City of Marshall is approximately 6.2 square miles and is located along the interchange of interstate 94 and 69. Geographically, the city is located approximately 50 miles south of Lansing and is 40 miles east of Kalamazoo. The four townships that surround the City of Marshall include Marshall Township, Marengo Township, Eckford Township, and Fredonia Township. Appendix A contains the 2010 United States census results for the City of Marshall and the surrounding townships.

A comparison of these communities to state averages reveals that the areas population is older and less diverse. Over the span of the last ten years the area has seen a decrease in approximately 1% of its total population which is below the average for the majority of the communities in Michigan. It is believed this retention is due in part to the superior services and facilities offered by the City of Marshall.

The plan that follows takes into consideration the geographical area mentioned above and attempts to coordinate efforts for State and National projects and trends. It includes recommendations for the next five years for park acquisitions, facility improvements, and program development to better reach and serve the public.

Administrative Structure

According to the City of Marshall's Code of Ordinances, the Parks, Recreation, and Cemetery Board is composed of seven members serving three year terms. Appointed by the Mayor, board members are comprised of City and/or Township residents. The board acts in an advisory capacity to the City Council and staff, aiding in the formulation of rules, regulations, policies and the annual budget. The board contributed to the master plan by holding a public meeting to discuss the initial survey results and a second meeting to review the master plan draft and recommend changes prior Planning Commission review.

The City of Marshall Parks and Recreation Departments are recognized as separate operating units. A cooperative working environment allows for the sharing of staff, equipment and expertise as needed. The Department of Public Works (DPW) is responsible for maintaining the facilities and reports to the Director of Public Services (see Appendix B for organizational chart). The DPW currently has nine full time employees and two seasonal part-time employees. These positions are financed through the general fund budget. The majority of general fund revenue is derived through property tax collection. Over the past few fiscal years, the budget for the Parks Department has been approximately \$90,000. The detailed budget includes the current

adopted budget, historical expenditures, and requested budget for fiscal year 2013 and a projection for fiscal year 2014 has been included in Appendix C. Following a national trend the City of Marshall has also begun to rely upon part time employees to fill the gaps left by attrition within the DPW.

In May of 2010 City Council voted unanimously to start an Adopt a Park program. In partnership with the DPW this program has improved our park system by encouraging community groups to take an active role in the care of our parks. The program has four main objectives: reduce litter, enhancement of the environment, beautification, and to foster broad-based community support. The program includes sixteen locations throughout the city eligible for adoption. Each location has specific needs; litter control, landscape maintenance, routine maintenance, facility and equipment improvement, and other improvements that the groups are willing to invest. Sponsors are required to report the number of people and hours volunteered. Currently seven of the sixteen areas have been adopted.

The Recreation Department staff encourages members of the community to participate in recreational activities by offering a wide variety of programming and reports to the Director of Community Services. The Recreation Department currently has three full time employees. Approximately 50% of the Department's operations are funded through a 0.9393 voter approved dedicated millage with the other 50% generated from user fees. The budget of \$400,000 has remained consistent for several fiscal years. The detailed budget which includes the current adopted budget, historical expenditures, requested budget for fiscal year 2013 and a projection for fiscal year 2014 has been included in Appendix D. Also, following the national trend, the Recreation Department relies heavily on part-time employees, interns, contracted employees and a strong volunteer base to fill its staffing needs.

Appendix E contains the most recent capital improvement plan from both Parks and Recreation which was adopted by City Council in January of 2012.

Currently the City of Marshall does not have any affiliation with other agencies. This plan addresses that deficiency and suggests improvements.

Recreational Inventory

According to the City of Marshall Code of Ordinances there are six properties classified as parks. These areas are:

Carver Park

Carver Park, located near the intersection of East Michigan Avenue and Exchange Street, is the focal point on the east end of the Central Business District. The park is less than an acre and has a lighted fountain, park benches, landscaping, art exhibits and a drinking fountain. It is used for a number of activities and festivals and is adopted by the Marshall Garden Club who maintains the plantings in the large flower gardens.

Brooks Memorial Fountain

Brooks Memorial Fountain Park is located in the center of the traffic circle at West Michigan Avenue and Kalamazoo Avenue. This park provides an impressive entrance to the Central Business District. Although it is less than one acre, survey results rate Brooks Memorial Fountain Park as the second most used facility in Marshall. Amenities include a lighted fountain, park benches, public address system, and trash receptacles. On Saturday, May 16, 2009, Brooks Memorial Fountain was turned on for the first time after undergoing an extensive restoration with funds raised in eight months by the GIFT Committee (Give to the Fountain Today). The white pillared fountain gracing the center of the west-end park was a gift to the City by its revered citizen and patron Mayor Harold C. Brooks (1925-1931) in memory of his father, Charles Esselstyn Brooks. It was

dedicated by him on April 26, 1930. With its 96 color variations of red, amber, blue, green and white and its center spray rising to a majestic height of thirty feet, the Brooks Memorial Fountain is a cherished symbol of the community. Currently the park is adopted by the Marshall Area Garden Club who plants and maintains the showy flower gardens that greet the community and visitors from all directions.

Marshall Athletic Fields Complex

The Marshall Athletic Field Complex is a four acre facility located on West Michigan Avenue. Amenities include; two lighted adult softball diamonds with 8' outfield fencing and electronic scoreboards, two youth softball/baseball diamonds with 6' outfield fencing, a score shed at each field, three lighted sand volleyball courts with a covered pavilion, shower tower, concession stand/restroom building, garage/equipment storage building, two drinking fountains, two basketball hoops, a play structure paved accessible pathways to all four diamonds and a 200 space paved parking lot.



With vigilant planning and scheduling Marshall Recreation Department programs such as men's softball, women's softball, co-ed softball, youth pitch baseball, girl's pitch softball, supervisor pitch baseball, coaches pitch baseball, coaches pitch girls softball and t-ball call the Athletic Field Complex home.



In 2010-2011 these programs provided recreational experiences for 1,711 participants. Through the generous financial support of the Cronin Foundation, a local charitable organization, the 2010-2011 fiscal year, also saw the completion of improvements and renovations that began in 2007. These renovations have helped provide better facilities for Department programs, have vastly improved the visual appeal of the facility and have also contributed to the dramatic increase in facility rentals for tournaments. The Marshall Athletic Field Complex is sought out by multiple

baseball/softball organizations as the ideal facility/location for their venues. It is estimated that the rental aspect of Recreation Department operations has added approximately 2,500 more participants as annual users of this facility. The increase in tournament rentals has also had a positive impact on the local economy. The Athletic Field Complex season is April – October.

Ketchum Park

Ketchum Park is a 25 acre facility located on the north and south sides of Rice Creek, from South Marshall Avenue to the eastern City limits. The Mill Race divides the park into what is known as North and South Ketchum. The north and south sections are connected by a pedestrian bridge, donated by the Marshall Rotary Club. This park is a favorite spot in the community and is used extensively for family reunions, company outings, and birthday parties. It has even been used on occasion for weddings and art venues.

North Ketchum includes; a small picnic shelter, picnic grills, picnic tables, restrooms, a small play structure and a 100' x 100' skate park. In 2009 YSIOALAYA, surfaced as a non-profit organization created specifically to improve the Marshall Skate Park. This third party group has been responsible for reinstating the skateboard committee, organizing a major fundraising campaign, expanding skateboard opportunities in Marshall through special events and has officially adopted the area. The fundraising efforts were a success and allowed for improvements, repairs and much needed additional equipment at the park. This has led to a significant increase in use. In December of 2011 the City of Marshall was awarded a grant in the inaugural year of the Passport

Grant Program. Funds are earmarked for installation of new doors and time locks on the restrooms, park signage and paving of the north parking lot.

South Ketchum includes; a large pavilion, picnic grills, picnic tables, a drinking fountain and Kids' Kingdom, a large wooden play structure. In 2009 South Ketchum underwent major physical changes as part of the dam removal project which diverted the flow of the Mill Race. Currently the space created by this project remains unstable with further leveling and construction needed. In 2005 South Ketchum benefited from the dedication of another third party organization. This group of local volunteers directed fundraising, community awareness, implemented a design contest with local students, researched companies specializing in community builds and ultimately was responsible for the construction of Kids' Kingdom. According to recent survey results these amenities at South Ketchum make it our third most frequented facility. South Ketchum is adopted by the Marshall High School Honor Society.



Stuarts Landing – Millpond Park

Stuarts Landing and Millpond Park, is located on the south side of the Kalamazoo River, near Homer Road. The park is a very popular for leisure activities and is the east entry to the Riverwalk. The 2 acre park includes paved parking, restrooms, picnic tables, and grills, benches, fishing dock, boat launch, gazebo and band shell. The park was originally developed and donated to the City of Marshall by the Stuart Family who continue to be involved in the park through the adopt a park program.



Brooks Nature Area (BNA)

The Brooks Nature Area is located along the shore of both Upper and Lower Brace (Stuart) Lake and was established as a Marshall City park on April 17, 2006. The City acquired this property in 1969, along with the land which later became the Brooks Industrial Park, from L. Alta Brooks, widow of Louis Brooks. Native prairie has been reestablished in an 88-acre section of the BNA through a partnership between the City of Marshall and the US Fish and Wildlife Service. Wildlife food plots are planted annually in four one-acre sections. The remaining 97 acres in the park are hedgerows, wetlands and wooded areas and offers picnic tables, scenic overlook benches, and bird houses. The Brooks Nature Area Advisory Board oversees the park and advises staff on improvements and currently is pursuing a deck installation that will overlook Brace Lake. A separate master plan is being developed for this impressive and important piece of park property. The park is currently adopted by the Stuart Lake Association.

In addition to the parks designated in the code of ordinances the City also maintains a number of other facilities.

The Riverwalk

The Riverwalk, identified as the most used park, consists of 1.5 miles of elevated boardwalk and paved a pathway which includes five pedestrian bridges, boat and canoe launches and scenic overlook areas. The Riverwalk follows both Rice Creek and the Kalamazoo River extending from Stuart's Landing to South Kalamazoo Avenue. The City of Marshall utilized Natural Resources Trust Fund Grants for this project. The Riverwalk is part of the North Country National Scenic Trail (Stuart's Landing listed on their website) and will partner with the Great Lakes to Lakes Trail project as this system develops. See Appendix F for a letter of support.

Other Open Spaces

Alcott Park, Weber Triangle, Garvin Property, and Cook Point are all open space-style parks, less than an acre, are scattered throughout the city. See Appendix G for a map of the above mentioned parks.

Accessibility Assessments

Below is a breakdown of the accessibility assessment using the following ranking system:

- 1 = none of the facilities/park areas meet accessibility guidelines
- 2 = some of the facilities/park areas meet accessibility guidelines
- 3 = most of the facilities/park areas meet accessibility guidelines
- 4 = the entire park meets accessibility guidelines
- 5 = the entire park was developed/renovated using the principals of universal design

- Carver Park - 4
- Brooks Memorial Fountain - 3
- Marshall Athletics Fields Complex - 3
- Stuarts Landing - 4
- Brooks Nature Area -3
- Ketchum Park - 3
- Riverwalk - 5
- Alcott Park - 1
- Weber Triangle - 2
- Garvin Property - 1
- Cook Point – 2

DNR Recreation Grant Inventory

The City of Marshall has a history of utilizing grant money to fund acquisitions and development. Appendix H summarizes the DNR recreation grant history. A total of \$867,900 has been awarded since 1980. Grants have been used to improve Ketchum Park, the Athletic Fields Complex, land acquisition and construction for the Riverwalk project. A comparison of the grant inventory elements and park descriptions shows that all of the elements listed still exist today.

School-Owned Facilities

Gordon Elementary School is 8 acres and serves the northeast section of the City. The outdoor recreation area is used year round for everything from free play on the equipment to winter sledding on the hill. The north side of the school includes; multiple climbers, swings, a large play structure, a softball field, a soccer field with goals and a fenced area containing 3 play structures, multiple climbers and balancing challenges. The south side of the school includes; 2 swing sets, a soccer field, a school age play structure rated for 5-12 years. A fenced in area geared for kindergarten students contains a geo-climber, swings and a small play structure. Indoor areas used for recreation include; a multi-purpose room and gymnasium.



Walters Elementary School is 10 acres and is located on the north side of the City adjacent to Marshall High School. The playground is located on the north or back side of the school and includes; a small soccer field with goals surrounded by a paved track, a pre-school age play structure rated for 2-5 years, a garden area with benches, gaga pit, swings, geo-climber, basketball court with 2 hoops and a school age play structure rated for 5-12 years. The outdoor play area is scheduled for upgrades in 2012. Indoor areas used for recreation include; a large cafeteria with stage, gymnasium with spectator seating and a wrestling room. Located just outside the cafeteria is an area with several picnic tables.



Hughes Elementary School is 7 acres and is located on the south side of the City. The west side of the school includes; a small paved track, soccer field with goals, and a basketball court with 2 hoops. The south side of the school includes; 2 large swing sets, a geo-climber, a “rocket” play structure and a school age play structure rated for 5-12 years. The east side of the school contains an additional large swing set, a basketball court with 2 hoops and a small play structure. Indoor areas used for recreation include; a multi-purpose room and a gymnasium with stage.



Marshall Middle School is a 7 acre facility and is located one block south of the central business district. Outdoor areas used for recreation are located on the south side of the school and include; a large play structure, a small play structure with swings, a softball field, basketball courts with 4 hoops, gaga pit and a large open space. Indoor areas used for recreation include; a large cafeteria, a full size gymnasium with spectator seating, balcony and a newly renovated auditorium with state of the art technology.



The Marshall High School site is 58 acres and is located on the north side of the City. Facilities used for both community recreation and High School sports include; 10 tennis courts with concession stand & restrooms, 3 mile cross country course, practice areas/open space, the indoor swimming pool, large cafeteria and gymnasium with spectator seating and balcony areas. Facilities used primarily for High School sports include; newly renovated varsity baseball field, Wise fast pitch field, soccer field, football field, weight room and the auditorium.

Marshall Academy is a K-12 tuition free charter public school located southeast of Marshall on Homer Rd. The facility is situated on 35 acres and includes plenty of open green space, a play structure, a geo-climber, a basketball hoop and a soccer/softball field. The school also has a full size gym with multi-purpose flooring.



Mar-Lee School is a K-8 tuition free public school located northeast of Marshall on H Drive. The facility is situated on approximately 10 acres and includes open green space, a play structure, a geo-climber, basketball hoops, a baseball field and a dirt track. Inside the facility is a full size gymnasium.

Other important facilities and activities

The Calhoun county fairgrounds are located in the south east section of the city and feature a 2,400 seat grandstand, a new modern stage/entertainment center, camping facilities, a historic church, a half mile horse track, and a number of open spaces and buildings. The fairgrounds hold events throughout the year and boast being Michigan's oldest fair.

There are two historic walks that guide pedestrians through The historic downtown area and through the historic neighborhoods throughout Marshall. The sidewalks are marked to help guide pedestrians along the designated routes and past museums and historic markers. There is also a designated walk that guides pedestrians through Oakridge Cemetery which directs and informs them on the most important people from the City of Marshall's history.

Description of the Planning and Public Input Process

In order to formulate an effective master plan that represents the community's wishes, it is imperative their voice be heard. The City of Marshall prepared a schedule allowing community member's ample review and input throughout the process. In October, staff met to discuss the timeline for the master plan and techniques to be used to gather public input. The following schedule was proposed:

October 13, 2011 - Kickoff meeting

October 25, 2011 – Present draft survey tool to PRC Advisory Board and gather input

November 4, 2011 - Meeting to refine community survey

November 14, 2011 to January 13, 2012– Community survey

January 13, 2012 to January 18, 2012 – Consolidate community survey results

January 19, 2012 – Present survey results to Brooks Nature Area Advisory Board and gather input

January 24, 2012 – Present survey results to PRC Advisory Board and gather input

January 24, 2012 to February 21, 2012 – Create draft master plan

February 22, 2012 Distribute draft plan for review to City staff

February 28, 2012 - Present draft plan at PRC advisory board

March 7, 2012 - Present draft plan to Planning Commission

March 14, 2012 to April 6 – Incorporate public comment into plan

April 16, 2012 – Present plan to City Council for adoption.

The City of Marshall utilized the services of Survey Monkey in order to reduce the cost of direct mailing. The raw data from the survey is included in Appendix I. Citizens that did not have access to the internet were asked to call and request a hard copy of the survey. The survey was advertised a number of ways including the City's website, Recreation Department website, facebook, bill inserts, Recreation Department e-newsletter, newspaper ads, public comment at a City Council meeting, established email listings like Marshall Web News etc... and through organizations like the Chamber of Commerce and the Marshall Public Schools. In an effort to reach out to township residents a direct mail postcard was distributed as a reminder to complete the survey. Survey respondents are identified from the City of Marshall and its surrounding townships. The results represent a sampling of potential users of the parks and recreation services offered by the City of Marshall. This is illustrated in the survey by the 50/50 split of city residents to non-residents and similar characteristic to the 2010 census data for age. The 246 surveys returned represent nearly 1,200 people or 8% of the areas population.

In addition to the survey, staff also solicited comments during several public meetings. Staff utilized the Brooks Nature Area Advisory Board, the Parks, Recreation, and Cemetery Board, the Planning Commission, and City Council. Citizens were invited to comment on the process and the plan at all of these venues with special newspaper invitations to the Planning Commission meeting and the City Council meeting after the draft plan was made public.

Staff elected to employ a systems approach planning in the development of this document. The unique character of the facilities and population of the City of Marshall does not lend itself well to a comparison method of planning. The systems approach method incorporates information gained from citizens and a detailed recreation inventory to determine the parks and recreation needs of the community. Projects that have been previously identified by staff, boards and citizens such as the community dog park and community ice rink were targeted in the survey.

Goals

In January of 2012 City Council adopted the 2012 City Visioning, Goals, Objectives, and Tasks. The goals were divided into four areas:

- Retain and enhance the existing employment base of the surrounding community by attracting commercial and retail uses within the central business district consistent with its historic character; attracting cultural, entertainment and similar destination businesses citywide; attracting research and development uses to the Brooks Industrial Park and other industrial uses consistent with existing industrial businesses within the City, all of which is measured to assess the impact of our actions on the economic vitality of our residents, businesses and industry.
- To create and promote a safe and unified community within our neighborhoods and businesses.
- Provide the community with available funding options for enhancing the taxing structure. Preserve, rehabilitate, maintain and expand all City infrastructure assets (roads, buildings and utility systems) and identify and determine funding options. Determine a self funded downtown parking study supported by the community – let the community guide the effort.
- To achieve and sustain a concentrated effort by policymakers and community to promote the standard of living and economic health of Marshall.

While none of these goals speak directly to the parks and recreation functions it is possible for the action plans highlighted to help achieve all of these goals. Below are goal statements that will be used to help guide the action item adopted in this plan:

1. Maintain and enhance existing parks locations and facilities.
2. Engage the growing majority of older adults through improved activities and facilities that connect with the interest of this demographic group.
3. Improve and invest in non-motorized infrastructure to link city parks and open spaces, attract tourism, and coordinate with county, state and national initiatives.
4. Continue trend of park improvements lead by citizen groups.
5. Insure proper spacing of parks and open spaces throughout community and facilities to encourage use.
6. Utilize survey results in recreation program development.

Action Program

Goal 1

There are a number of activities to help the City of Marshall accomplish these goals and a number of projects can help accomplish multiple goals. From the survey results it is clear the most valuable park assets the City has are the Riverwalk, Brooks Memorial Fountain, and Ketchum Park.

The existing riverwalk was built with grant funding and there is a desire to extend this facility. The planned extension would occur from South Kalamazoo Avenue to the west. Any further construction shall be built to AASHTO standards with the goal of being included in the Great Lakes to Lakes trail. (See Appendix F for letter of support) This would clearly enhance the Riverwalk facility and the non-motorized recreation opportunities for the community.

Brooks Memorial Fountain has become the iconic symbol of the City of Marshall. The recent renovation revealed the City had not properly planned for large maintenance and technological upgrades necessary for this facility to remain in working order. Currently, the City designates a portion of the annual budget to address these concerns in the future. It is recommended this be continued and if excess revenue becomes available that the fund be considered.

Ketchum Park has a number of features that attracts families. The survey revealed two major concerns with South Ketchum in direct relation to users of Kid's Kingdom; restroom are not in close proximity to the play structure and there is not adequate parking. These public concerns should be a high priority as enhancements to this park are considered.

Goal 2

The population on a whole is growing older and Marshall appears to be leading that trend. The survey indicated an interest in travel for this segment of the population. Presently, the recreation department offers an annual bus trip to the Grand Hotel on Mackinac Island. As the number of Department staff has been reduced over the last two years additional travel opportunities may be investigated by partnering with privately run companies. The survey also indicated a slight interest in passive recreation/social gatherings. Currently, the Marshall House Apartments in cooperation with Community Action offers a congregate meal site w/ recreation opportunities year round on Monday, Wednesday, and Friday. "Senior Day" held on Thursdays at Maplewood of Marshall began in 2012 and includes; space for cards and other self-guided activities, refreshments, scheduled entertainment and soup/sandwich at noon. The recreation department will explore methods in which it may assist in the effort to inform the community about the events/activities that are on-going. The department may also assist these organizations with equipment and supplies.

Additional activities that older adults illustrated as desirable during the information gathering portion of the plan include shuffleboard, canoe rental, horse shoe pits, bike routes, and a dog park. These features should be considered when updating existing parks or developing new locations.

Goal 3

As part of the 2012 City Visioning, Goals, Objectives, and Task the City Council directed the staff to devise a non-motorized plan. The plan will identify the existing infrastructure, help to develop relationships with agencies responsible for that type of infrastructure improvement, select projects, and gather public input. In coordination with this plan the projects should link the City of Marshall's existing parks and open spaces while reviewing enhancements like a mountain bike trail. These improvements should be done in a way to help facilitate the anticipated trail way that will pass through Marshall.

Goal 4

The City of Marshall has a long history of community involvement. Through grass roots organization significant enhancements have been made throughout our local park system including; Kid's Kingdom, the skate park, the Athletic Field Complex and Brooks Memorial Fountain. As the City is faced with fewer staff and budgetary challenges this trend should be continued, encouraged and sought after with regards to the desire, documented by the survey to have a dog park or a community ice skating rink. .

Goal 5

Recently, the City of Marshall and the Marshall Public Schools reviewed the safety of their existing playground equipment. This review resulted in the removal of a number of features. In doing so, the distribution of equipment has become unbalanced throughout the community. The City can be geographically separated into four quadrants using the major roads that bisect the community. An inventory has revealed a deficiency in the North West and South West quadrants. It is recommended that these two quadrants receive priority consideration over the next five years with regards to open space purchases and equipment installation.

Goal 6

Recreation for a Lifetime.... the Department's slogan was adopted by the Advisory Board many years ago. What better way to ensure "Recreation for a Lifetime" than to examine comments and suggestions gathered in the survey which represents all age groups. As future program development is considered the following have been identified as being of interest in our community. Environmental programming (composting, recycling, nature walks), horseshoes, shuffleboard, outdoor activity clubs (running, walking, biking), adult & youth flag football, adult floor hockey, card/game leagues for older adults, yoga in the park, arts & crafts for teens, family trips (sporting events & museums), middle school dodge ball league, gymnastics, enrichment classes (pet training, How To, knitting/crocheting), summer pre-school camp, Gymboree for under 4, community gatherings for activities (biking, walking, Frisbee) and archery.

Appendix A - Census Data

Population	1990	2000	2010
Eckford Township	1,217	1,282	1,303
Fredonia Township	1,741	1,723	1,626
Marengo Township	1,801	2,131	2,213
Marshall Township	2,655	2,922	3,115
City of Marshall	6,891	7,459	7,088
Total	14,305	15,517	15,345

Race	White	African Amer	Asian	AIAN	NHPI	Other	Two or more races
Eckford Township	1,587	0	7	10	0	5	17
Fredonia Township	1,269	4	10	5	0	2	13
Marengo Township	2,135	15	5	4	1	17	36
Marshall Township	3,015	6	15	19	0	29	31
City of Marshall	6,739	76	52	40	3	52	126
Total	14,745	101	89	78	4	105	223
State of Michigan Race Breakdown	7,803,120	1,400,362	238,199	62,007	2,604	147,029	230,319

Gender	Male	Female
Eckford Township	663	640
Fredonia Township	818	808
Marengo Township	1,070	1,143
Marshall Township	1,515	1,600
City of Marshall	3,369	3,719
Total	7,435	7,910
State of Michigan Age Breakdown	4,848,114	5,035,526

Age	Under 18	18-19	20-24	25-34	25-49	50-64	65-over
Eckford Township	310	26	61	116	286	310	194
Fredonia Township	350	34	67	164	321	415	275
Marengo Township	504	56	84	185	463	503	418
Marshall Township	732	68	108	239	676	775	517
City of Marshall	1,703	170	375	836	1,331	1,383	1,290
Total	3,599	354	695	1,540	3,077	3,386	2,694
State of Michigan Age Breakdown	2,344,068	304,817	669,072	1,164,149	2,022,555	2,017,449	1,361,530

APPENDIX B CITY OF MARSHALL - ORGANIZATION CHART

As of 9/20/11

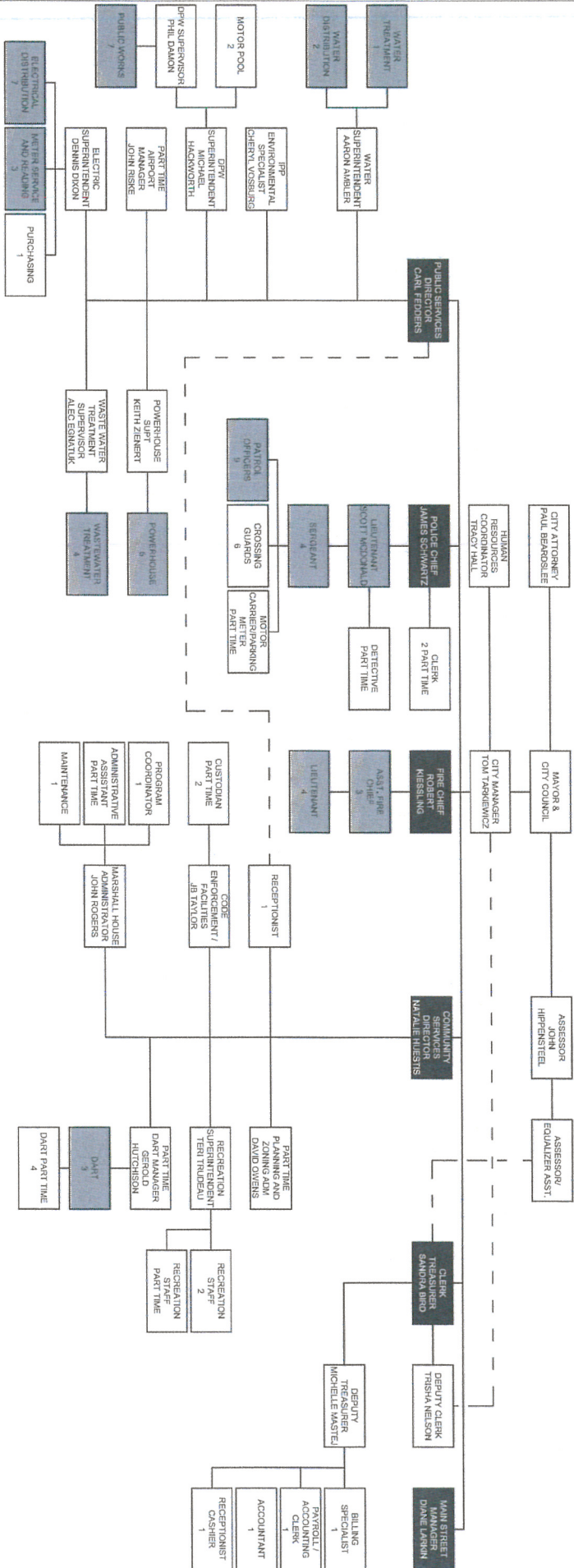

Appendix C - Budget

City of Marshall		2008-09	2009-10	2010-11	2011-12	YTD	2011-12	2012-13	2013-14
PARKS		Actual	Actual	Actual	Budget	Dec-2011	Estimate	Request	Projected
<i>Summary of Dept Totals</i>									
Expenditures									
101-774-702.00	PAYROLL	34,191	35,618	11,932	12,489	6,027	12,489	11,387	11,500
101-774-702.01	OTHER FRINGE BENEFITS	0	0	0	1,385	0	1,385	1,493	1,664
101-774-703.00	PART-TIME SALARIES	7,091	13,107	14,213	19,065	4,917	19,065	19,065	19,065
101-774-704.00	OVERTIME SALARIES	2,205	334	0	0	85	85	0	0
101-774-715.00	SOCIAL SECURITY	3,251	3,675	1,973	2,111	838	2,526	2,444	2,466
101-774-716.00	HEALTH BENEFITS	4,256	4,972	220	241	45	241	1,065	1,176
101-774-717.00	LIFE INSURANCE	30	49	42	23	15	23	26	26
101-774-718.00	RETIREMENT	4,458	3,857	4,861	957	2,163	5,191	6,593	8,043
101-774-719.00	HOSPITALIZATION-PRESCRIPTION	0	0	0	0	0	0	0	0
101-774-721.00	WORKERS COMPENSATION	268	4,423	3,762	3,876	1,781	1,781	3,762	3,875
101-774-740.00	OPERATING SUPPLIES	5,184	7,596	4,030	4,000	1,325	4,000	4,000	4,000
101-774-755.00	MISCELLANEOUS SUPPLIES	0	0	0	0	0	0	0	0
101-774-760.00	MEDICAL SUPPLIES	42	135	59	0	62	0	0	0
101-774-775.00	REPAIR & MAINT. SUPPLIES	1,797	3,557	13,067	3,000	873	3,000	3,000	3,000
101-774-777.00	MINOR TOOLS	5	675	531	440	37	440	440	440
101-774-801.00	PROFESSIONAL SERVICES	41	846	0	600	200	600	600	600
101-774-810.00	DUES & MEMBERSHIPS	0	0	0	0	0	0	0	0
101-774-820.00	CONTRACTED SERVICES	5,466	3,223	1,001	2,580	1,377	7,080	2,580	2,580
101-774-922.00	UTILITIES - ELECTRIC	17,639	10,805	11,829	11,000	6,855	11,000	11,000	11,000
101-774-930.00	EQUIPMENT MAINTENANCE	0	0	77	500	0	500	500	500
101-774-939.00	CONTRACTED MAINTENANCE	1,130	1,124	450	950	450	950	950	950
101-774-941.00	MOTOR POOL EQUIPMENT RENTAL	8,962	14,313	19,561	22,100	6,134	22,100	21,000	21,000
101-774-941.01	DATA PROCESSING	300	895	0	0	0	0	122	143
101-774-958.00	EDUCATION & TRAINING	0	0	0	0	0	0	0	0
	Parks - Expenditures Total:	96,318	109,205	87,608	85,316	33,184	92,457	90,016	92,027

Appendix D Budget

City of Marshall

Recreation		2008-09	2009-10	2010-11	2011-12	YTD	2011-12	2012-13	2013-14
		Actual	Actual	Actual	Budget	Dec-2011	Estimate	Request	Projected
Summary of Dept Totals									
Revenues									
208-000-402.00	CURRENT PROPERTY TAXES	174,137	180,511	197,793	195,644	193,303	193,303	189,024	189,024
208-000-420.00	DEL. PERSONAL PROP. TAX	643	592	372	550	0	550	0	0
208-000-445.00	PENALTIES & INT. ON TAXES	623	742	641	600	21	600	0	0
208-000-587.00	LOCAL RECREATION GRANTS	0	128	0	0	0	0	0	0
208-000-641.00	CONCESSION SALES	0	0	0	0	0	0	0	0
208-000-651.00	USE FEES	208,499	211,169	212,962	203,472	75,824	200,005	199,038	201,094
208-000-665.00	INTEREST	5,387	2,241	1,529	2,020	1,218	2,020	2,020	2,020
208-000-671.00	MISCELLANEOUS REVENUE	302	175	445	875	0	666	1,000	1,000
208-000-675.23	CONTRIBUTIONS - SCHOLARSHIPS	-558	0	0	0	0	0	0	0
208-000-694.00	CASH - OVER & SHORT	-237	-5	-131	0	131	0	0	0
Recreation Revenues Total:		388,797	395,553	413,612	403,161	270,497	397,144	391,082	393,138
Expenditures									
208-751-702.00	PAYROLL	143,128	149,400	141,254	126,398	53,877	126,398	127,664	128,941
208-751-702.01	OTHER FRINGE BENEFITS	0	0	0	3,353	3,335	3,353	3,555	3,758
208-751-703.00	PART-TIME SALARIES-TAXABLE	24,399	20,915	28,945	40,672	19,971	36,944	34,361	28,800
208-751-703.01	PART-TIME SALARIES	26,450	25,718	26,249	27,122	12,266	26,952	24,353	24,459
208-751-704.00	OVERTIME SALARIES-TAXABLE	86	3	445	1,288	87	1,288	1,288	1,288
208-751-715.00	SOCIAL SECURITY	12,563	12,714	12,838	13,136	5,799	12,851	12,765	12,453
208-751-716.00	HEALTH BENEFITS	30,565	44,812	35,887	30,022	12,401	30,022	33,313	37,185
208-751-717.00	LIFE INSURANCE	281	346	332	308	129	308	308	312
208-751-718.00	RETIREMENT	11,745	10,003	12,588	14,558	5,600	14,558	17,915	21,856
208-751-720.00	UNEMPLOYMENT	0	2,242	0	0	615	615	0	0
208-751-721.00	WORKERS COMPENSATION	1,490	3,962	3,370	3,355	1,596	1,596	3,370	3,471
208-751-727.00	OFFICE SUPPLIES	1,991	2,728	1,171	2,475	282	2,475	2,497	2,497
208-751-740.00	OPERATING SUPPLIES	77,467	65,022	67,562	73,077	24,489	73,562	71,036	70,179
208-781-755.00	MISC SUPPLIES	0	2,498	2,206	2,504	197	2,504	2,842	2,565
208-751-776.00	BUILDING MAINT. SUPPLIES	165	0	249	300	63	300	400	400
208-751-801.00	PROFESSIONAL SERVICES	582	529	794	830	833	830	830	830
208-751-810.00	DUES & MEMBERSHIPS	475	470	540	450	494	494	405	415
208-751-820.00	CONTRACTED SERVICES	8,714	13,534	13,553	13,528	5,647	14,270	13,965	14,100
208-751-825.00	INSURANCE	248	175	177	271	81	170	179	184
208-751-850.00	COMMUNICATIONS	1,418	1,256	1,146	1,200	501	1,200	1,260	1,260
208-751-860.00	TRANSPORTATION	623	351	462	794	0	794	794	0
208-751-902.00	MARKETING	342	113	113	350	0	430	350	0
208-751-922.00	UTILITIES - ELECTRIC	3,877	4,215	3,744	4,662	2,645	4,662	4,860	4,860
208-751-930.00	EQUIPMENT MAINTENANCE	669	0	545	1,025	0	1,025	1,025	1,025
208-751-931.00	BUILDING MAINTENANCE	1,161	1,145	1,212	1,188	59	1,188	60	332
208-751-940.00	RENTALS	14,274	13,274	13,274	11,460	5,730	11,460	13,299	12,996
208-751-941.00	MOTOR POOL EQUIPMENT RENTAL	9,238	7,996	9,572	10,572	3,881	10,572	10,000	10,000
208-751-941.01	DATA PROCESSING	5,326	7,956	7,667	7,205	3,002	7,205	7,647	8,979
208-751-958.00	EDUCATION & TRAINING	1,002	348	497	738	75	738	720	0
208-751-964.00	REFUND OR REBATES	43	37	2,496	0	880	880	0	0
208-751-970.00	CAPITAL OUTLAY	23,559	0	3,850	0	0	7,500	19,800	13,700
208-751-999.00	TRANSFERS TO OTHER FUNDS	0	832	0	0	0	0	0	0
Recreation Expenditures Total:		401,883	392,596	392,737	392,841	164,286	397,144	410,862	406,844

Appendix E Capital Improvement Plan

Record #	Department	Project Title	Priority Ranking	Estimated Useful Life	Source of Funding	2012-2013 Expenditure	2013-2014 Expenditure	2014-2015 Expenditure	2015-2016 Expenditure	2016-2017 Expenditure	2017-2018 Expenditure	Trade In or Grant Share	Total Expenditure
Recreation													
77	Recreation	Seal Coating & Striping Athletic Field Parking Lot	2	5	General Fund	\$0	\$7,500	\$0	\$0	\$0	\$0	\$0	\$7,500
253	Recreation	Concrete Pads Under Spectator Bleachers	2	20	General Fund	\$5,000	\$0	\$0	\$0	\$0	\$0	\$0	\$5,000
254	Recreation	Replace Electronic Scoreboards, Diamond #1 & #2	2	15	General Fund	\$0	\$11,000	\$0	\$0	\$0	\$0	\$0	\$11,000
82	Recreation	Athletic Field Sign	3	20	General Fund	\$0	\$0	\$5,000	\$0	\$0	\$0	\$0	\$5,000
255	Recreation	Dug-Outs, Diamond #3 & #4	3	25	General Fund	\$0	\$0	\$0	\$12,544	\$12,544	\$0	\$0	\$25,088
58	Recreation	Replacement of Athletic Field Light System	4	15	General Fund Transfer to Electric Fund - Bond	\$0	\$0	\$0	\$0	\$0	\$0	\$300,000	\$300,000
122	Recreation	Dug Outs	4	10	General Fund	\$0	\$0	\$0	\$0	\$0	\$0	\$25,088	\$25,088
Parks													
207	Parks	Playground Ground Cover replacement	1	10	General Fund	\$0	\$0	\$0	\$0	\$0	\$0	\$8,000	\$8,000
12	Parks	Purchase New Playground Equipment	2	25	General Fund	\$45,000	\$0	\$0	\$0	\$0	\$0	\$0	\$45,000
55	Parks	Paving North Kelchum Park Parking Lot	2	20	General Fund 25%, Passport Grant 75%	\$6,250	\$0	\$0	\$0	\$0	\$0	\$0	\$6,250
183	Parks	North Kelchum Park Time Locks With New Doors	2	30	General Fund 25%, Passport Grant 75%	\$3,750	\$0	\$0	\$0	\$0	\$0	\$0	\$3,750
124	Parks	Brooks Nature Park Observation Deck	2	20	Special Projects Fund-Brooks Nature Project Fund Balance from 100% DNR Grant	\$0	\$0	\$0	\$0	\$0	\$0	\$0	\$0
180	Parks	Master Plan for Brooks Nature Park	2	10	Special Projects Fund-Brooks Nature Project Fund Balance from 100% DNR Grant	\$0	\$0	\$0	\$0	\$0	\$0	\$0	\$0
249	Parks	Brooks Nature Park, 16 x 20 Shelter	2	20	Special Projects Fund-Brooks Nature Project Fund Balance from 100% DNR Grant	\$0	\$0	\$0	\$0	\$0	\$0	\$0	\$0
277	Parks	S. Kelchum Park Leveling	3	10	General Fund	\$45,000	\$0	\$0	\$0	\$0	\$0	\$0	\$45,000
192	Parks	Sherman Court Pond Nature Trail	4	20	General Fund	\$0	\$5,000	\$5,000	\$5,000	\$5,000	\$0	\$0	\$15,000

Appendix F Letter of Support



P. O. Box 1382 Battle Creek, MI 49016

Board of Directors

President

Larry Rizor
Architects, Inc.

Secretary

Michael Van Houten
Albion College

Treasurer

Ron Sootsman
Pfizer, ret'd.

Past President

Thomas Garnett
Borgess Battle Creek

Directors

James Coury
*Calhoun County
Conservationist, ret'd.*

Linda Freybler
*Calhoun County
Visitors Bureau*

William Greer
Kellogg Company

Barbara Ley
Denso, ret'd.

Chris Miller
*Village of Homer,
President*

Kristy S. Orns, CPA
*Fisher, Spiegel, Kunkle &
Gerber, P.L.L.C*

Melva Parker
*Fort Custer Horse
Friends*

Mark Stuart
Stuart Law Offices PC

James Whitehouse
Nature Conservancy

March 19, 2012

Mr. Carl Fedders, PE
900 S. Marshall Ave
Marshall, MI 49068

Dear Mr. Fedders:

The Calhoun County Trailway Alliance (CCTA) would like to formally endorse the City of Marshall's new 5 Year Recreation Plan. The CCTA is very excited that Marshall is updating their Recreation Plan and that the new plan will contain expansions and improvements to the Marshall River Walk.

The fact that the City of Marshall's Recreation Plan will include the extension of River Walk to the west and that the River Walk will be designed, where possible, to meet AASHTO standards for biking will enhance the City's ability to secure grants for construction. These improvements will allow the River Walk to become an important part of the Calhoun County Trailway and help to close the gaps in the Great Lake-to-Lake Trail from South Haven to Port Huron.

If the CCTA can provide any assistance to the City of Marshall with your Recreation Plan or the planning of the River Walk extension or improvements, please feel free to contact me.

Sincerely,

A handwritten signature in cursive script that reads "Larry Rizor".

Larry Rizor
President, Calhoun County Trailway Alliance

Appendix G - Designated Parks

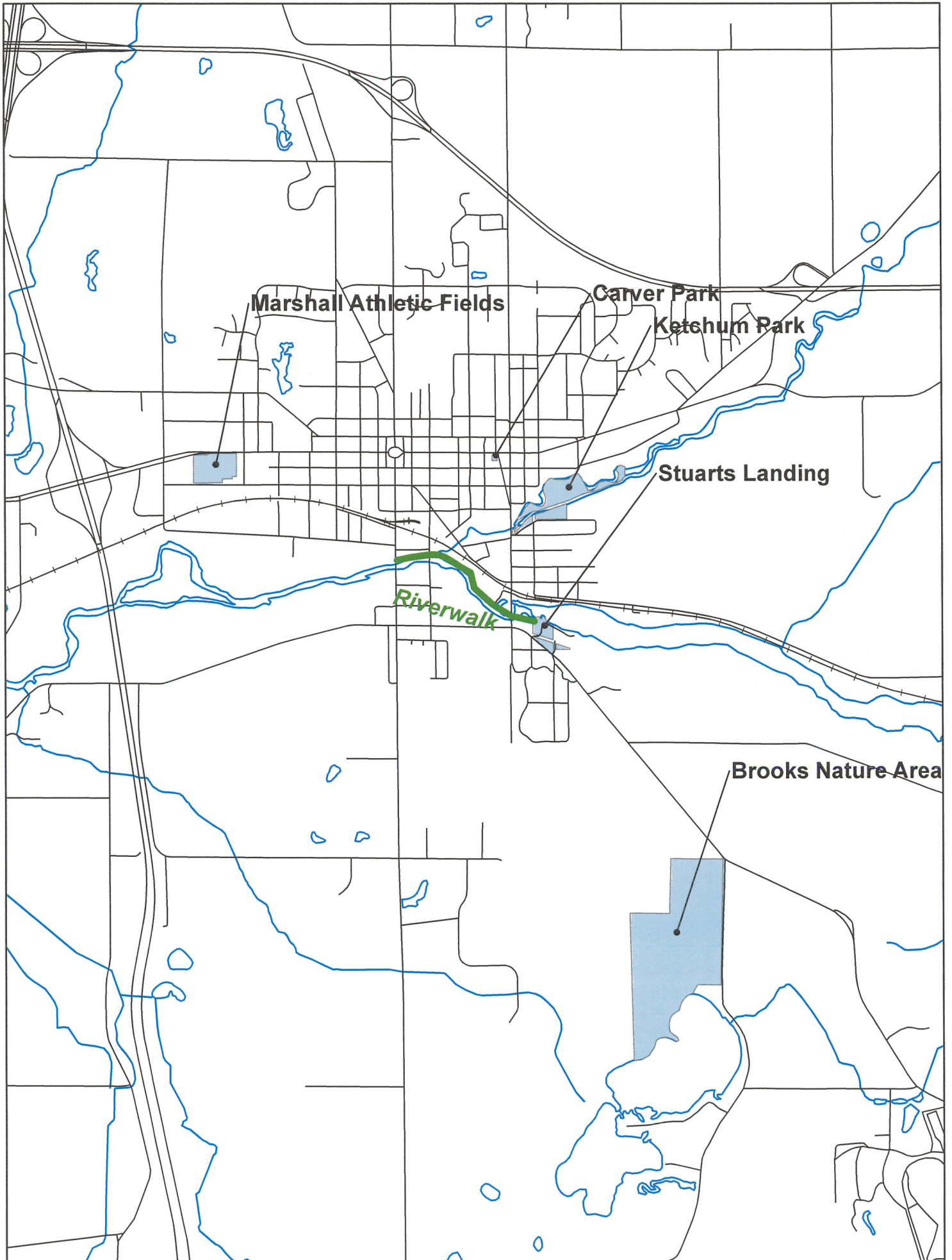

Appendix G - Open Spaces

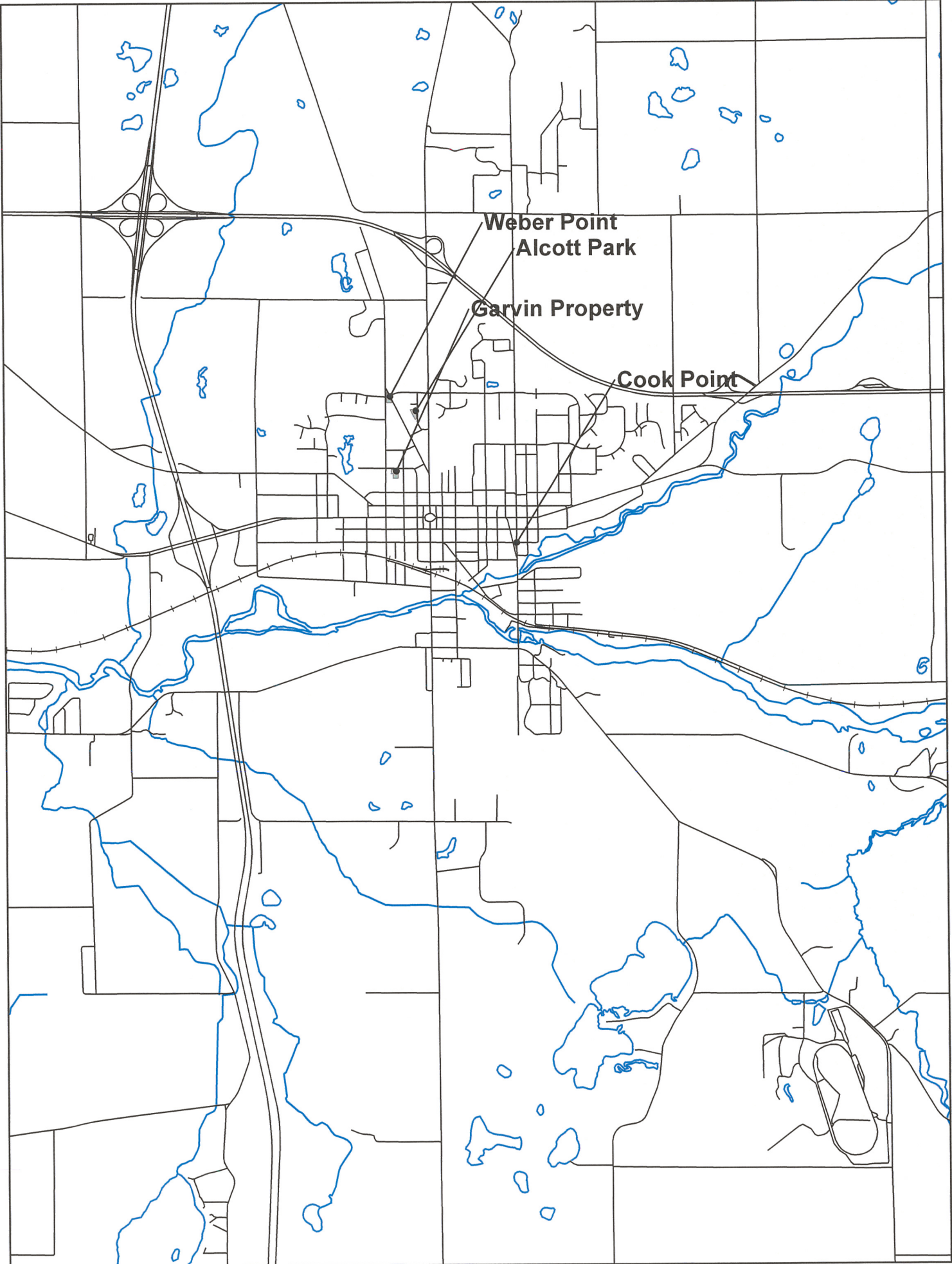

Appendix G - Schools

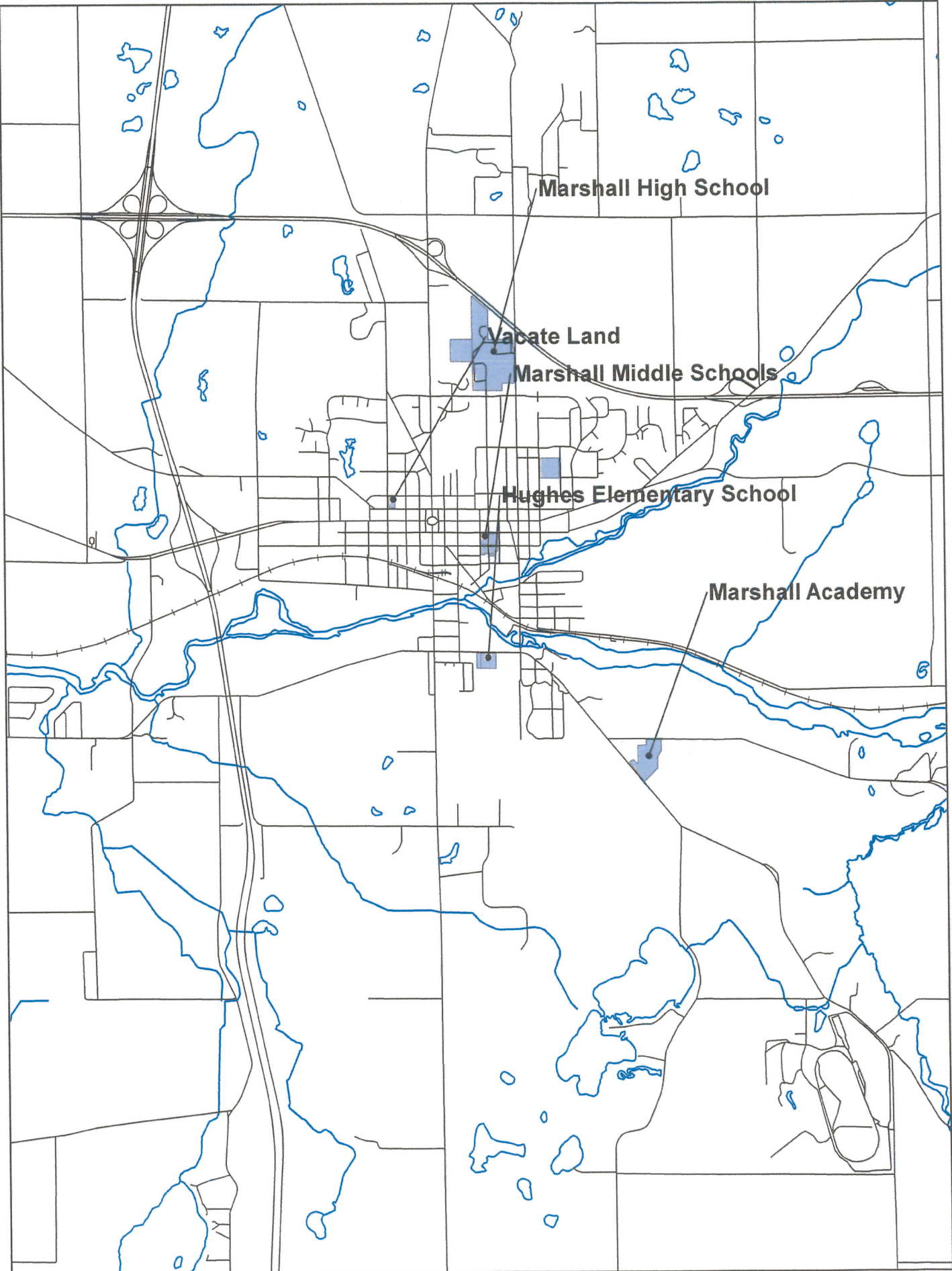



Recreation Grant History

Applicant

City of Marshall

Project No. 26-01104 J

Project Year: 1980

Project Title: Ketchum Park

Project Status: Closed

Grant Amount: \$20,274.36

Project Description: restroom/utility building including sewer and electrical, picnic shelter, shuffleboard courts, with fencing, horseshoe pits, benches and picnic equipment, playscape, parking lot, LWCF sign

Project No. BF93-155

Project Year: 1993

Project Title: Athletic Field Renovation

Project Status: Closed

Grant Amount: \$81,500.00

Element

Element

Restroom/Concession

Playscape

Replace Fence

Construct New Field

3 New 5-Row Bleachers

Fence - New Field

Replace Bleacher Boards

4 Drinking Fountains

Improve Drain

Backstop

8 Player Benches

Project Description: Construct restroom/concession storage facility, replace fencing, improve drainage, replace/repair bleachers, replace playscape, construct new field, relocate transformer, install four drinking fountains.

Project No. TF94-078

Project Year: 1994

Project Title: Waterfront Trail Development

Project Status: Closed

Grant Amount: \$157,500.00

Element

Element

Trail

Signage, Etc.

2 Pedestrian Bridges

S. Marshall Avenue Access

Restroom Building

Boat Launch Improvements

Parking

Construct Boardwalk

Project Description: Develop bike/pedestrian trail on Kalamazoo River. Construct flush restroom facility at Stuart's Landing on the Mill Pond. Improve Mill Pond boat launch. Provide parking at launch and at trail access points.



Recreation Grant History

Applicant

City of Marshall

Project No. TF98-027

Project Year: 1998

Project Title: Marshall Riverfront Trail-Stage III

Project Status: Closed

Grant Amount: \$29,203.00

Project Description: Acquire three Kalamazoo River frontage properties (.83 acres) to help secure future development of the Marshall trail, and promote interaction with the river's habitat.

Project No. TF98-040

Project Year: 1998

Project Title: Riverfront Trail-Stage II

Project Status: Closed

Grant Amount: \$358,000.00

Element
Site Preparation
Topographic Survey
Boardwalk Construction
Barrier-Free Ramp
Parking Areas
Site Amenities

Element
Concrete Walks
Landscaping
Paved Walkway

Project Description: Development of a barrier-free pedestrian trail along the Kalamazoo River, including parking areas, boardwalks, paved walkways, barrier-free ramp and overlook decks.

Project No. TF00-139

Project Year: 2000

Project Title: Riverwalk Development

Project Status: Closed

Grant Amount: \$191,444.00

Element
Site Preparation
Boardwalk
Parking Area
Fishing/Viewing Decks
Site Lighting and Electrical
Paved Walkways

Element
Site Amenities
(Benches/Signs/Waste Recept.)
Landscaping and Restoration

Project Description: Development of barrier-free boardwalk and paved trails along 1,100 feet of the Kalamazoo River between Monroe Street and Kalamazoo Avenue; construct parking area, ramp and overlook decks to promote access to the Kalamazoo River.



Recreation Grant History

Applicant

City of Marshall

Project No. RP11-412

Project Year: 2011

Project Title: Ketchum Park Improvements

Project Status: Active

Grant Amount: \$30,000.00

Element

28-car asphalt parking lot

2 restroom doors with time locks

Park identification sign

Project Description: Development to include parking lot, restroom doors and park identification sign.

Appendix I – Survey Results

Where do you live?

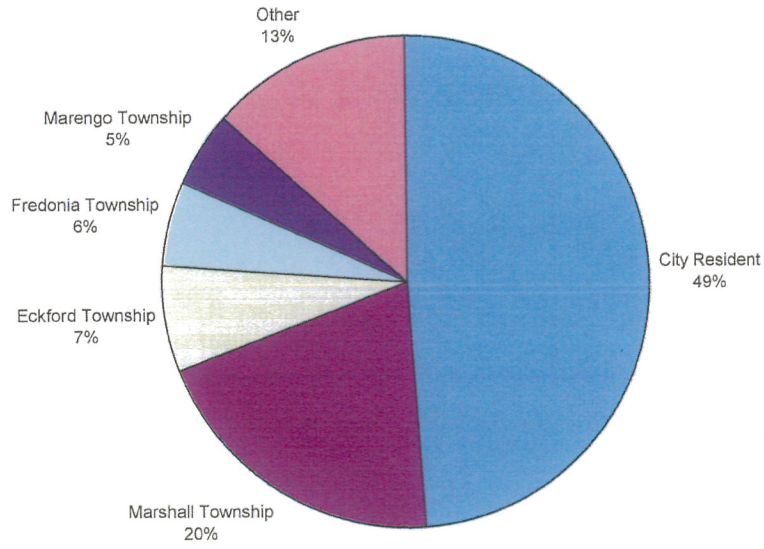

Age of people the survey represents

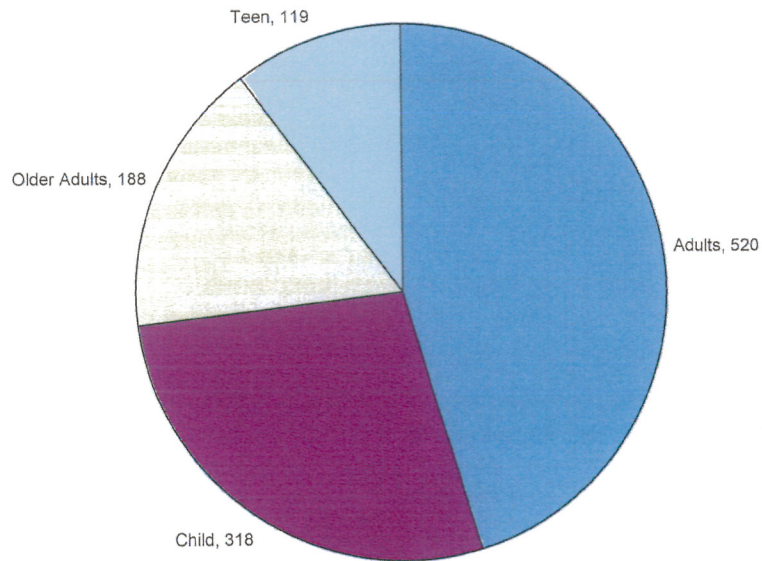

What Parks do you use?

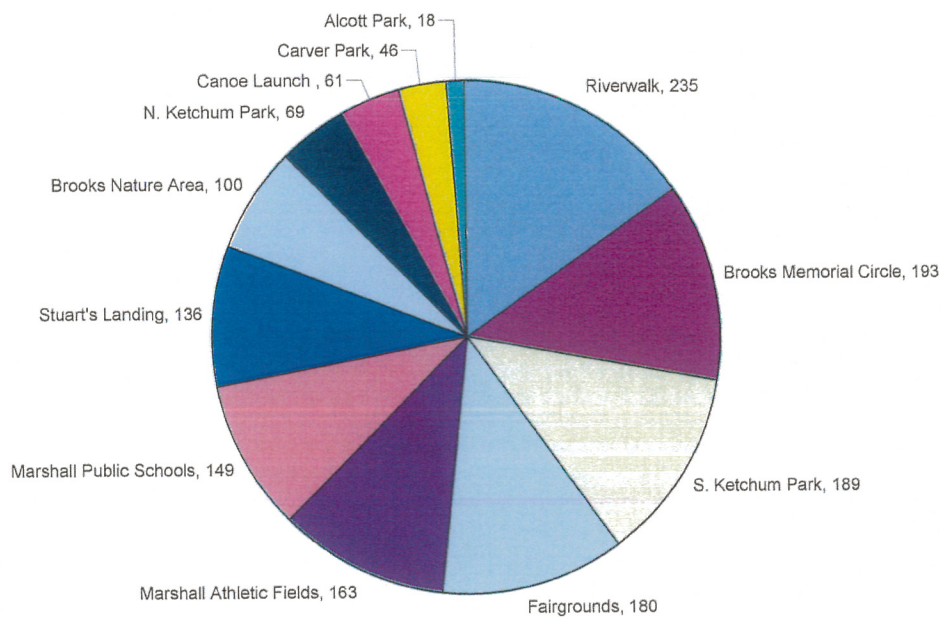

Are you satisfied with the quality and amenities of the parks/facilities in the City of Marshall?

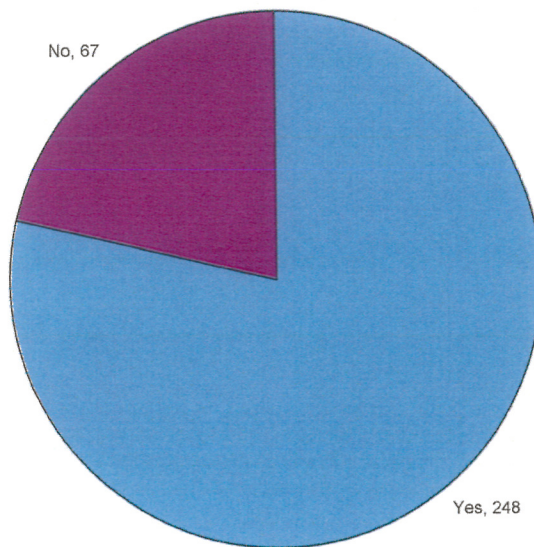

How often would you use an outdoor ice skating rink?

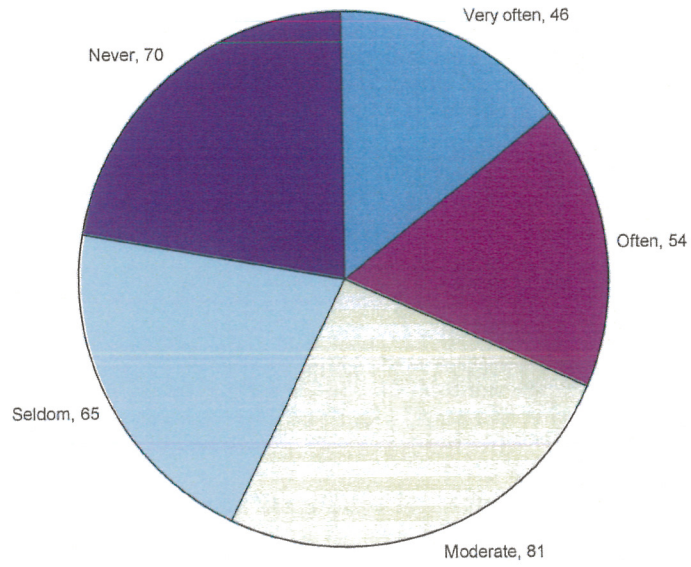

How often would you use a public dog park?

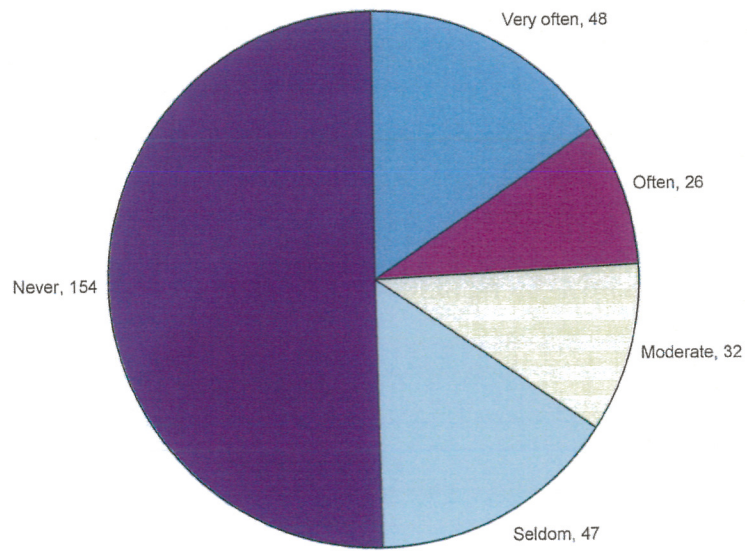

Would you pay to use a dog park or a outdoor ice skating rink?

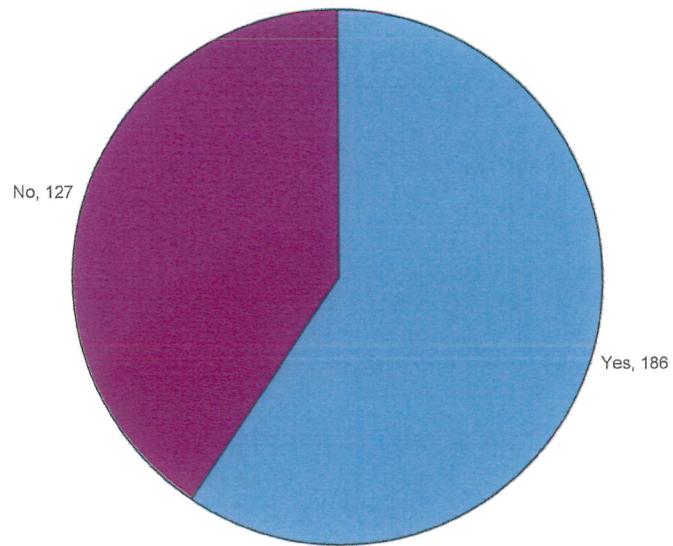

Do you or your family members participate in any Marshall Recreation Department activities?

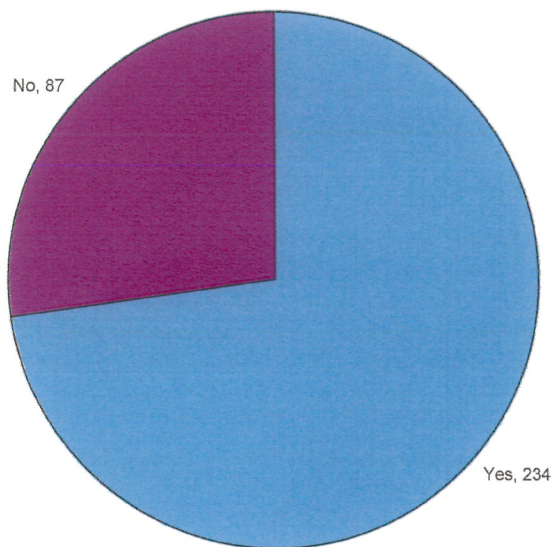

Are you satisfied with the programs and services the Marshall Recreation Department offers?

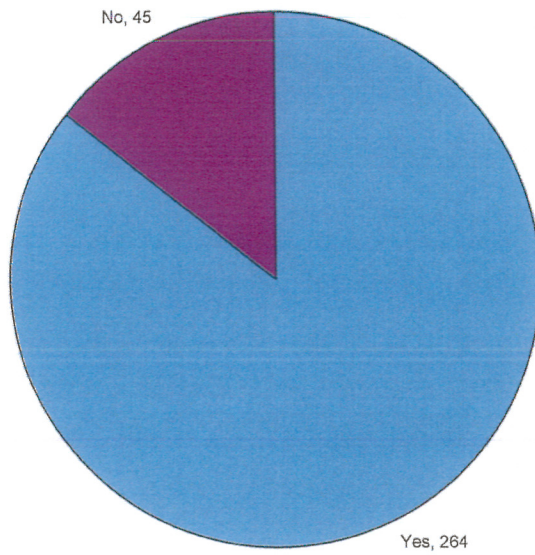

What barriers do members of your family experience that may inhibit use of the Marshall Parks and Recreational programs?

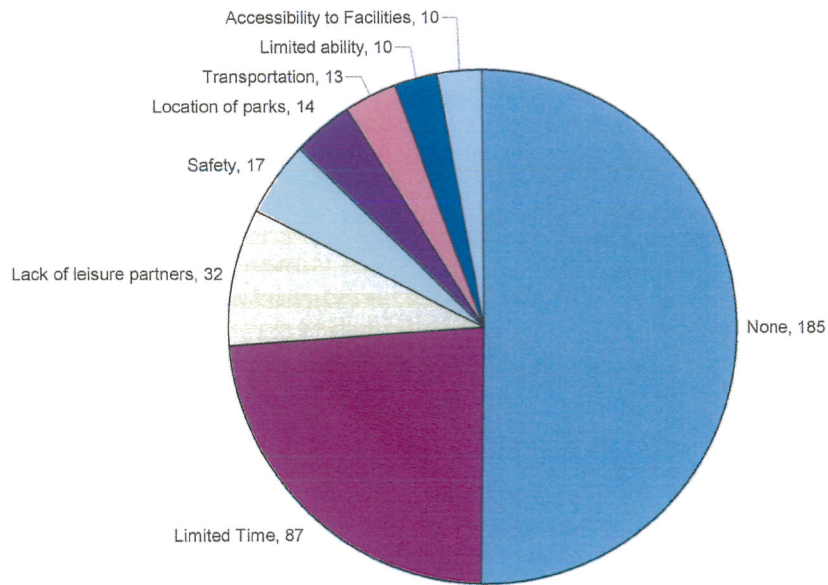

What is the best way to communicate with you and your family?

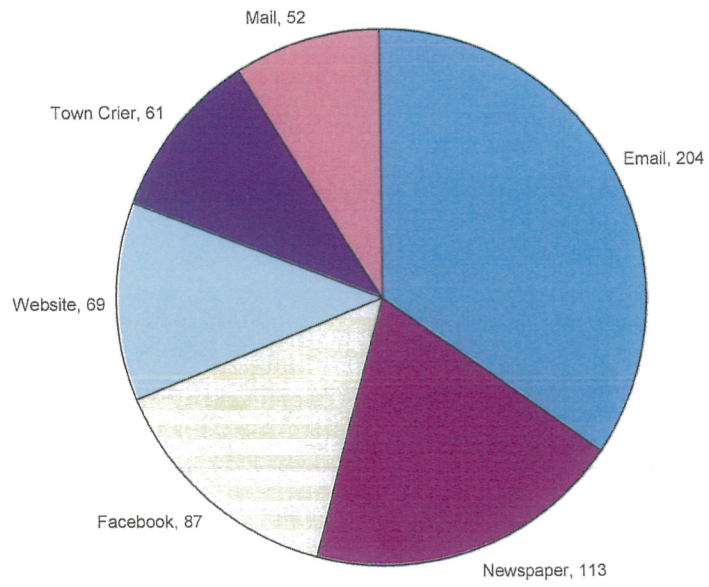

We are new to area, better marketing of what is offered is needed. We do not know how to find out what is available where and when.
I pay about \$100 for Parks and Recreation on my city taxes but if a non-resident utilizes the same program they pay only \$10 more than I do. The non-resident charge needs to increase, I am not seeking a reduction in millage.
As a tax payer I am charged a fee to play in organized sporting activities. I feel that I am already paying my fee through taxes. The out of city residents should be charged more to cover outside expenses. They pay no taxes and slightly higher fee.
we need a nice dog park!!!
I would highly recommend considering an off-leash dog park (for small and lg dogs). I recently read in the newspaper that the committee for the Sherman School is considering demolishing this building (if they can't sell it)...this would be a great location for a dog park and an accessible place where all could enjoy! Great way to get out and meet ppl.
More environmental programs for kids & adults (composting, recycling, nature walks, etc.)
More educational informational services about the natural formation, history and beauty of the river, parks, trees, etc.
It would be great to have a public ski and sled hill with a tow rope and public ice skating in the greater Marshall community.
Longer walking / bicycle trail
Consider setting up a bicycling program where people could join others for local casual cycling cruises (not competitive or long distance).
For future consideration, we would like to see trail connections between the new industrial park and Brooks Nature Area. Also, consider a trail connection between the Kalamazoo River Walk and the Brooks Nature Area.
There are no equestrian trails in Calhoun County. The Horse Industry contributes 8 Billion to the states economy. There are 3,000 horses in Calhoun County and 3,000 in Kalamazoo County. Keep their money in your community by providing areas to recreate.
Expand youth sports, more walking and biking trails
Bike rides, public outdoor pool, sledding, would not pay fee for dog park-should be free for visitors
Would like to see Recreation Department take charge of "The Dump" bike trail, rather than having private individuals run it. Personally I am puzzled why the City allows private individuals to operate on public lands. The City could enhance it much better, and make it accessible to all. They could also add safety features, like rest areas, signage, brush removal and proper grading for portions of the trail.
New equipment to replace older, worn out equipment.
The city ruined the S ketchum park when they drained the river section. Please dig a nice big fish pond in it's place !!!
Wish there was a bathroom at Kids Kingdom, even outhouse
Kids kingdom needs a bathroom.
The riverwalk desperately needs some time & effort put to it. <input type="checkbox"/> When Ann Adams was in charge of this walk it was kept up and widely used. Please just take a walk on this walk and you will soon see the repairs that need to be made. The River Walk desperately need some TLC!!!!!!
Please consider changing the old Shearman School site to a park/playground.
How about turning the Shearman School site into a new city park?
I would LOVE to see the Sherman School turned into a local park. We sorely miss the playground there already! We need to spruce it up around there.
Perhaps a card/game league for adults. Maybe tie it into the Marshall House.
I would like to see more choices in activities. Lacrosse, soccer and volleyball for youth.
I would like to see the Recreation Department try to take over the east portion of the fair property that is in risk of foreclosure, and develop it into a camping type park.
Satisfied, however our son recently enjoyed the indoor floor hockey and it was just too short! How about a longer season and more practices, as is done with baseball/softball?
Is rec ONLY sports? Perhaps another question would identify the 1)programs 2)services and whether we do/would avail ourselves of them.You get interest number then.

Create a better baseball program
later start times for baseball & t-ball for working parents. Weekday evening activities instead of weekend ones.
would like to see a local hockey program.
Mostly satisfied, need lacrosse
A recreation center for seniors; my wife and I are forced to go to Battle Creek or Albion: difficult at times in winter
Nothing for older adults.
Better organization. Compared to WPMC, programs are lacking.
Officials for vball. More consistency on receiving schedules in a timely manner. Improve sand vball court.
An improved girls softball program.
Would like to see more family bus trips like to Tiger's games and Mackinaw Island.
Cost doesn't meet the expectations. Youth sports shirts generic, no numbers. I have volunteered to coach: coach pitch baseball, floor hockey, and basketball and the City Recreation theory of 2 practices to "teach" youth new to a sport is ridiculous. Practice facilities are unacceptable, ie floor hockey, the cafeterias, "seriously", then you don't even get the proper equipment to teach/practice the sport. No goal nets, how would you like folks to teach goalie skills, forwards/guards to stay out the crease? Certainly doesn't make it easy or worth while to coach, when you get City Recreation, minimal equipment and facilities. Probably do to the cost of renting the gym as opposed to cafeterias.
more practice time, more training for couches
Would always like to see more student programs like lacrosse & track field
But I did feel that the Tennis program was not as effective as it could have been... I did provide feedback on another survey, however, so I will not repeat.
Would love summer playground with younger kids or more activities in the summer for pre-school aged children.
The baseball program needs to improve on the quality of play, coaching and Umpires if you are going to keep participation at an acceptable level and not lose players to the travel leagues.
Wish could have more leagues
However, it would be nice to have more things for younger kids 3-5
Growing up, we had a strong flag football program that allowed kids who aren't ready to compete in Rocket Football a chance to play football with their friends. I'd recommend looking into this if possible.
tee ball should be for pre-schoolers 4 years and 5 years at discretion of parents some children never hit from tee's they just learn to hit.
More activities for the younger ages 2-3 yrs.
Have more competitive teams for Womens. Have coaches for the boys that really know how to play the game & coach the boy on how to play the positions & what to do in certain situations
I would like to see more programs and activities offered that are not strictly centered around athletics.
Yes, satisfied, but would like to see more family bus trips...beyond just sporting events. Example...to the museums in Chicago or Great America in Illinois.
like to see more baseball teams and sports for kids not picked for school sports invite surrounding cities to play against your older teams instead of playing the same team every week
For a new family moving to town, it's almost impossible for an older teen/young adult to join a sports team. When we called, we were told the teams put themselves together - and they were all full. Being new, we didn't know people to organize our own team. This is a BIG disappointment.
More fitness activities would be nice, especially during daytime hours.
expanded softball programs, especially for women
More structured at the children level of recreation sports. Right now (specially baseball its a joke
More adult classes.
I would like to see more activities geared towards teens - possibly summer activities, gatherings
Would like to see senior activities during the summer months
Floor hockey back to the spring. More sports for adults, like flag football!

Older Adult (55 years or older)	Adult (18-54 years)	Teen (13-17 years)	Child (12 years and younger)
Art Fair around the Fountain	2 40 and over softball league fastpitch softball A dog park, and more river walk would be wonderful	arts&crafts Baseball and Softball with more players (or travel) basketball for those who don't make the team Casual, not-so-competitive sports/activities.	"Gymboree" type program for the under 4 age group a few day summer/fall camp outing A place for kids like Kids N Stuff in Albion
better maintained parks in general			after school activity center
Bicycle routes	Adult Ed.		
bike paths	Adult Floor hockey		
			Also would like to see a public restroom downtown like in Carver Park or in the shopping district and a childrens playset in Carver Park to attract people downtown. Would like to have a second youth basketball league so the season is longer for those that choose. Floor hockey for 7th & 8th Grade is missed. Appropriate practice time for teaching any sport. 3 practices is inefficient.
bike paths	adult volleyball/wallyball/pickleball etc...	city pool-better maintained parks in general	Baseball
Bike paths, lg park w/large picnic area	arts & crafts; ex'rcise class for moms/adult women(not fit);pet training/games	community activities/gatherings at certain parks for frisbee, bike rides, skate park - how too's	Baseball and Softball with more players (or travel)
bike routes	better maintained parks in general	community center for teens	
bike trails	Bike and walking trails	competitive baseball,youth football	
Card and Game league over the winter. Extension of Riverwalk to west along river, and the the east through the old railroad bed.			baseball,youth football
Cards	BIKE ROUTES bike trails	dances floor hockey	bathrooms Battle Creek offers a variety of recreational sports for younger children comparative to Marshall. Floor Hockey, Basketball and Baseball are a few examples
Christmas tree lighting ceremony	Bike trails/paths/lanes through and around town.	Girls softball	
Connect our Parks and Trails with biking /hiking trails	Christmas tree lighting ceremony	higher level of sports competition in baseball	BIKE ROUTES
descendant bike routes	clean bathrooms	ice hockey, ice skating	Crafts
Dog Park	community center with indoor/outdoor running track	ice hockey, lacross,golf,cricket	dodge ball
dog park	community pool. like coldwaters.	Knitting crocheting crafts	Flag Football
dog park	couple night out, babysitting services included	Lacross	Flag football
dog park, bicycle lanes/trails(brings in tourists!)	Covered farmers market.	lacrosse/ maybe floor hockey	flag football for k-5, Flag Football program
Dog Park, Skating Rink	dog park		

educational ops; trips	evening shopping hours downtown	More fields for softball/baseball for travel teams and tournaments, needs additional gym space for basketball games and tournaments; ice skating; outdoor pool. The Heritage complex in Coldwater is very nice and has pool, outdoor basketball hoops as well as gym for basketball	Floor Hockey
Equestrian Trails	family event	more lacrosse! bus trip to rock concerts (especially smaller venues for lesser known bands that are still worth seeing)	floor hockey
golf league, horseshoes, shuffleboard,swimming,walking group ice skating	Flag football league Flag Football program	more sports, outdoor options (lacrosse, archery, orienteering?) none	football Girls softball gymnastics basics - Jackson rec. has a nice intro program
in the park yoga series	floor hockey floor hockey, womens basketball	park yoga	
Keeping the river walk cleaned off	leagues, mens volleyball	Someplace to BE	Gymnastics classes
long walking trail (5 miles with no autos) low cost swim facility	Floor hockey. Soccer. hockey	summer baseball Teen Center Teen entertainment, Estilo activity	I would love to see a floor hockey "camp" for 3-5 year olds. The "Lil" programs you guys offer are awesome. Something between soccer and basketball would be nice. ice hockey, ice skating
more bike trails and bike lanes	ice rink. possibly make new pond in S ketchum park for skating and fishing.	Center has the right idea but could benefit by some city support	ice hockey, lacross, golf, cricket
moutain biking trails None	ice rink; outdoor pool; nice park with areas to grill Ice skating	teen hangouts. wear we could hang out. do homework. have wifi Volleyball	Ice skating Ice Skating Rink for sure
None	ice skating, ice hockey, woman's basketball kayaking (oil spill ruined my almost daily family trips)	Volleyball, Soccer, Lacrosse, Dodgeball, Course on how to referee and umpire.	Lacrosse league (just clinic offered)
none non-impact exercise options/family events	Love to see outdoor movies in the summer		lacrosse/better baseball program Love the ice skating idea.
not sure there is anything lacking park poor, too much stuf at Ketchum Park public swimming pool	more hiking and biking trails more organized sports teams, running program More theatre, movies		More fields for softball/baseball for travel teams and tournaments, needs additional gym space for basketball games and tournaments; ice skating; outdoor pool. The Heritage complex in Coldwater is very nice and has pool, outdoor basketball hoops as well as gym for basketball More floor hockey with better equipment and planning. More sports

same as answer in #8	More useable access to the kzoo river (canoe rental?), more river walk.	more sports for 3-4 year olds; floor hockey multi purpose building specific for recreation use n/a...think you've got 'em covered! organized play groups
shuffleboard shuffleboard, horseshoes Something safe.	Mountain bike trail. mountain biking trails none	Park or playground hours for smaller children. Meaning no teenagers swearing or older kids exhibiting inappropriate behavior. The bathroom facilities at Kids Kingdom are too far away for small children not to have accidents as well. park yoga Pre-school age programs
There just isn't much Tiger baseball,travelogue program Walking Groups Walking trails with fitness stations; picnic areas; Walking Works Club, Community Garden, Card Leagues	None none None None nothing to add except perhaps more bus trips	pre-teen activity -social/fun day public pool, splash park, ice skating - hockey,
We feel that Marshall goes above and beyond to reach all members of the community in its parks/recreation department. We have lived here most of our lives and have enjoyed all of its offerings as our children grew up and now even if we can't use them all, our grandchildren are. Marshall cares about all of its residents!!! Thank you! Would like to see more integrated age options (senior mother, 40-something daughter) Would like to see window painting again at Halloween. Would love to see a senior center in Marshall X	Official mountain biking trails Open gym time (pick up games) outdoor activity clubs (running, biking, etc. Outdoor public pool Overland Rally Racing park yoga Public bike trail at "The Dump". Card and Board Game league over the winter. Public Garden - fruits/vegetables/flowers and bike lane Public ski.sled/snowboard hill with tow rope and ice skating Restaurants, evening hours soccer Thank you for asking us!	Public ski.sled/snowboard hill with tow rope and ice skating she likes clean bathrooms too Sledding hill summer softball volleyball Volleyball volleyball for 10 -12 Volleyball, Soccer water park-better maintained parks in general young children's classes(mommy&me);arts-type classes

Appendix J - Resolution

**Parks and Recreation 2012-2017 Master Plan
For City of Marshall
Calhoun County**

WHEREAS, the *City of Marshall* has undertaken a planning process to determine the recreation and natural resource conservation needs and desires of its residents during a five year period covering the years 2012 through 2017, and

WHEREAS, the City of Marshall began the process of developing a community recreation and natural resource conservation plan in accordance with the most recent guidelines developed by the Department of Natural Resources and made available to local communities, and

WHEREAS, residents of the *City of Marshall* were provided with a well-advertised opportunity during the development of the draft plan to express opinions, ask questions, and discuss all aspects of the recreation and natural resource conservation plan, and

WHEREAS, the public was given a well-advertised opportunity and reasonable accommodations to review the final draft plan for a period of at least two weeks, and

WHEREAS, a final public comment session was held on *April 16, 2012* at *City Hall* to provide an opportunity for all residents of the planning area to express opinions, ask questions, and discuss all aspects of the recreation and natural resource conservation plan, and

WHEREAS, the *City of Marshall* has developed the plan as a guideline for improving recreation and enhancing natural resource conservation for the City of Marshall and all other residents of the planning area, and

WHEREAS, after the public meeting, the *City Council* voted to adopt said the 2012-2017 Parks and Recreation Master Plan.

NOW, THEREFORE BE IT RESOLVED the *City of Marshall* hereby adopts the *2012-2017 Parks and Recreation Master Plan*.

Yeas: _____

Nays: _____

Absent: _____

I, Sandra Bird, Clerk-Treasurer, do hereby certify that the foregoing is a true and original copy of a resolution adopted by the City of Marshall's City Council at a Regular/Special Meeting thereof held on the second day of April, 2012

Sandra Bird, Clerk-Treasurer