

PROJECT LOCATION:
CALHOUN COUNTY, MI

SHEET INDEX	
GENERAL SHEETS	SHEET NO.
COVER SHEET	C0.
EXISTING CONDITIONS	C1.
OVERALL SITE PLAN	C2.
SITE PLAN (1 OF 4)	C2.
SITE PLAN (2 OF 4)	C2.
SITE PLAN (3 OF 4)	C2.
SITE PLAN (4 OF 4)	C2.
SITE PLAN PARKING LOT VIEW	C2.
ROADWAY CROSS SECTION	C2.
OVERALL UTILITY PLAN	C3.
UTILITY PLAN (1 OF 4)	C3.
UTILITY PLAN (2 OF 4)	C3.
UTILITY PLAN (3 OF 4)	C3.
UTILITY PLAN (4 OF 4)	C3.
PAVING & ROADWAY DETAILS	C4.
SIDEWALK DETAILS	C4.
OVERALL GRADING PLAN	C5.
GRADING PLAN (1 OF 4)	C5.
GRADING PLAN (2 OF 4)	C5.
GRADING PLAN (3 OF 4)	C5.
GRADING PLAN (4 OF 4)	C5.
OVERALL LANDSCAPE PLAN	L1.
PARKING LOT LANDSCAPING OVERVIEW	L1.
LANDSCAPE DETAILS (1 OF 2)	L1.
LANDSCAPE DETAILS (2 OF 2)	L1.
ARCHITECTURAL SHEETS	SHEET NO.
FIRST FLOOR COMPOSITE PLAN	A-110
EXTERIOR ELEVATIONS – NORTH	A-201
EXTERIOR ELEVATIONS – EAST / WEST	A-202
EXTERIOR ELEVATIONS – SOUTH	A-203
SITE LIGHTING PHOTOMETRIC PLAN	1 OF 1
ELECTRICAL SITE DETAILS	ES501
ELECTRICAL SITE DETAILS	ES503

CONTACTS	
CLIENT	FORD MOTOR COMPANY 17000 ROTUNDA DR, 1ST FLOOR S. DEARBORN, MI 48120
ARCHITECT	SSEO GROUP 1050 WILSHIRE DR. STE. 260, TROY, MI JOHN HEIDT JHEIDT@SSEO.COM
ELECTRIC	CONSUMERS ENERGY BRENDA BRACE BRENDA.BRACE@CMSENERGY.COM
SURFACE WATER MANAGEMENT	CITY OF MARSHALL – STORMWATER MARGUERITE DAVENPORT, PE 269-781-5183 MDAVENPORT@CITYOFMARSHALL.COM
SOIL EROSION CONTROL	CALHOUN COUNTY ROAD DEPARTMENT 13300 15 MILE RD., MARSHALL, MI 269-781-9841
MUNICIPALITY	CITY OF MARSHALL – PUBLIC SERVICES MARGUERITE DAVENPORT, PE 269-781-5183 MDAVENPORT@CITYOFMARSHALL.COM

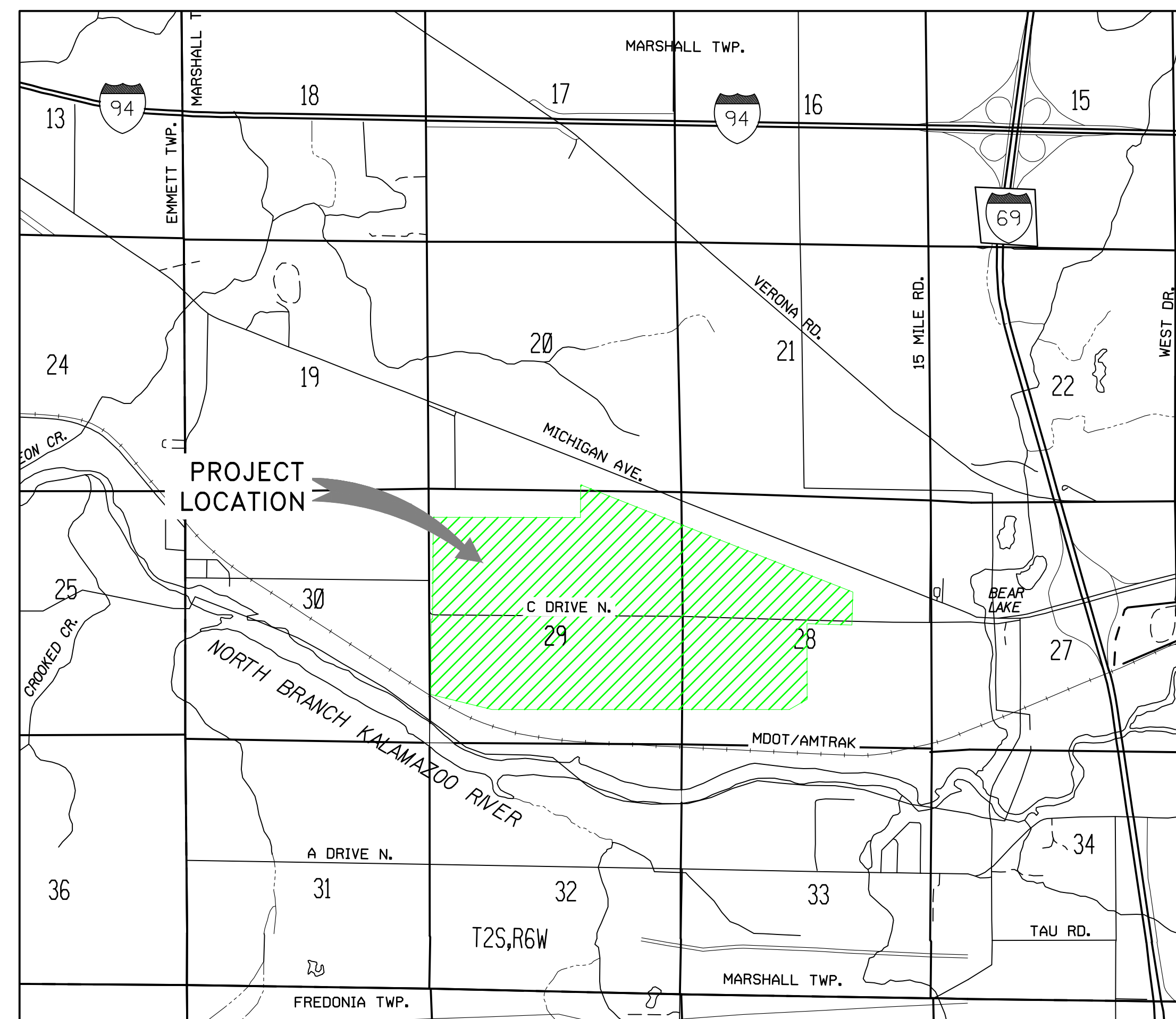

FORD MOTOR COMPANY PARCEL
LEGAL DESCRIPTION OF LAND
LOCATED IN SECTIONS 20, 28 & 29, T2S, R6W,
MARSHALL TOWNSHIP, CALHOUN COUNTY, MICHIGAN

BEGINNING AT THE W 1/4 CORNER SECTION 29, T2S, R6W MARSHALL TOWNSHIP, CALHOUN
COUNTY, MICHIGAN,

THENCE S 89°58'17" E 33.00 FEET ALONG THE E-W 1/4 LINE OF SAID SECTION 29 TO THE EAST RIGHT-OF-WAY LINE OF 13 MILE ROAD;

THENCE N 00°22'04" E 2157.32 FEET ALONG SAID EAST RIGHT-OF-WAY;

THENCE S 89°55'40" E 3122.60 FEET;

THENCE N 00°25'58" E 695.21 FEET;

THENCE S 68°23'07" E 3245.71 FEET;

THENCE S 68°35'27" E 2960.81 FEET;

THENCE S 01°39'06" W 699.69 FEET;

THENCE N 88°20'54" W 954.00 FEET ALONG THE E-W 1/4 LINE OF SECTION 28, T2S, R6W, MARSHALL TOWNSHIP, CALHOUN COUNTY, MICHIGAN & THE CENTERLINE OF C DRIVE NORTH (66.00 FEET WIDE) TO THE CENTER OF SAID SECTION 28;

THENCE S 00°08'50" E 1947.49 FEET ALONG THE N-S 1/4 LINE OF SAID SECTION 28;

THENCE N 71°18'28" W 397.60 FEET;

THENCE N 90°00'00" W 6312.27 FEET;

THENCE N 76°09'31" W 1337.71 FEET;

THENCE N 00°16'51" E 1599.81 FEET ALONG THE WEST LINE OF SAID SECTION 29 TO THE POINT OF BEGINNING, BEING A PART SECTIONS 20, 28 & 29, T2S, R6W, MARSHALL TOWNSHIP, CALHOUN COUNTY, MICHIGAN AND CONTAINING 731.40 ACRES OF LAND, MORE OR LESS, BEING THE INTERESTS OF THE PUBLIC OVER THAT PORTION OF LAND AS OCCUPIED BY C DRIVE NORTH (66.00 FEET WIDE). BEING SUBJECT TO EASEMENTS AND RESTRICTIONS OF RECORD, IF ANY.



Know what's **below**.
Call before you dig.



17000 ROTUNDA DR, 1ST FLOOR SOUTH
DEARBORN, MICHIGAN 48120-1168
USA



BUILDING SITE CODE
FORD PROJECT NUMBER

XXX

FORD PROJECT NUMBER



PROJECT NUMBER

WAR2004 01H

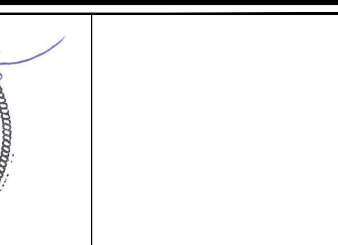

THIS DRAWING HAS BEEN PREPARED BY OR ON BEHALF OF FORD MOTOR COMPANY. FORD MOTOR COMPANY RETAINS ALL COMMON LAW, STATUTORY AND OTHER RESERVED RIGHTS INCLUDING COPYRIGHTS. THIS DRAWING SHALL NOT BE USED FOR ANY PURPOSE OTHER THAN PERFORMING SERVICES DIRECTLY OR INDIRECTLY TO FORD MOTOR COMPANY, WITHOUT THE EXPRESSED WRITTEN PERMISSION OF FORD MOTOR COMPANY. UNAUTHORIZED USE, COPYING OR MODIFICATION, INCLUDING THE REMOVAL OF THIS NOT, MAY CONSTITUTE A VIOLATION OF CIVIL OR CRIMINAL LAWS ENFORCEABLE BY FORD OR GOVERNMENTAL AGENCIES.

COPYRIGHT © FORD MOTOR COMPANY (2009)

COPYRIGHT © FORD MOTOR COMPANY 12

- [illegible]

04/25/2023 • SITE PLAN APPROVAL

04/14/2023 • SITE PLAN PRE APPLICATION

DATE	ISSUED FOR
------	------------

J CIESIELSKI

DRAWN BY: M KAMINSKI

DESIGNED BY: S DODSON

CHECKED BY: B NARTKER

APPROVED BY: E SMITH

SHEET TITLE

EXISTING CONDITIONS

FORD DWG N

REV. #

SHEET NUMBER

C1.0



Know what's **below**.
Call before you dig.

PRELIMINARY
NOT FOR CONSTRUCTION

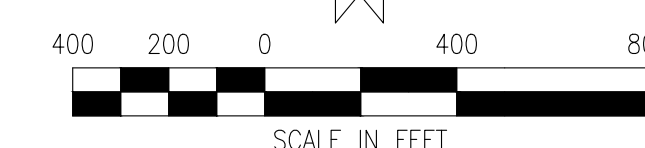



25251 Northline Rd
Taylor, MI 48180
734.947.9700
www.wadetrtrim.com

25251 Northline Rd
Taylor, MI 48180
734.947.9700
www.wadetrims.com

STATE OF MICHIGAN
ERICH VINCENT SMITH
ENGINEER
NO. 45867
LICENSED PROFESSIONAL ENGINEER

COPYRIGHT © FORD MOTOR COMPANY (2006)

DATE	ISSUED FOR
------	------------

C2.2

C2.2



PRELIMINARY
NOT FOR CONSTRUCTION

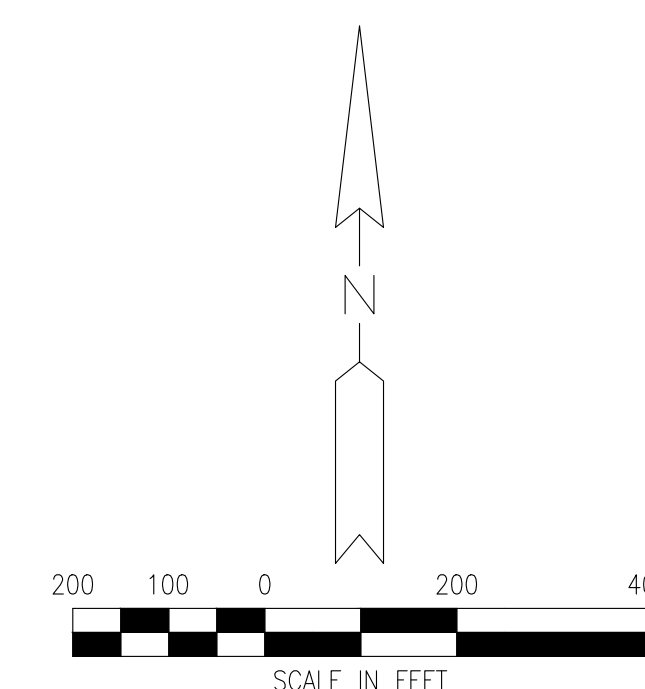

SCALE IN FFF

[illegible]

LEARNING GOALS

407,000 4,214,000 4,621,000

OF DATE: 10/21/2003 4:45 PM

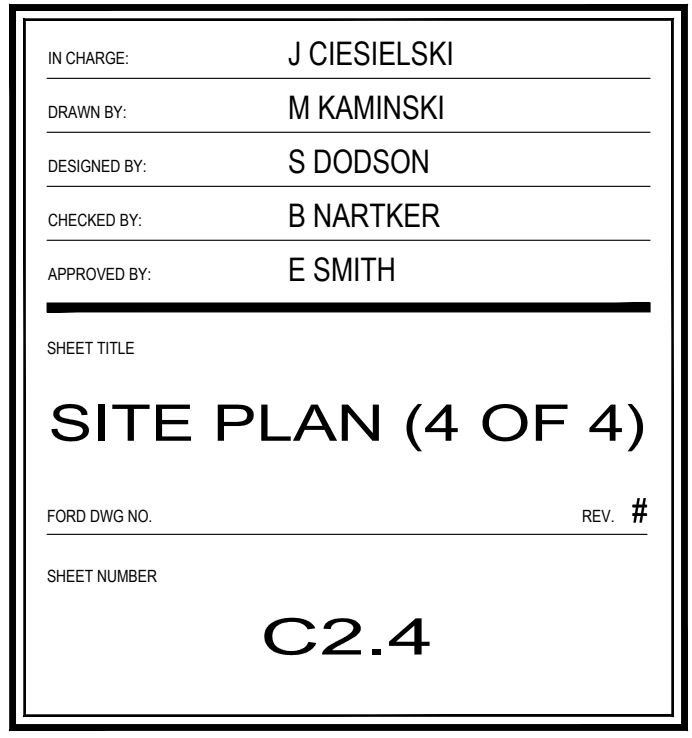

PLOT DATE: 4/25/2023 4:15 PM	SAVE DATE: 4/25/2023 1:34:49 PM	CANNA, RYAN	C:\Users\raman\Documents\Wade_Tim\FRQ2011-05F Project History\Project Files\01 Design\Civil_3DPhase 01\Plan Sheets\SPA\2000000-001-CU-SITE-A22-WADE.dwg
------------------------------	---------------------------------	-------------	---



**WADE
TRIM**



COPYRIGHT © FORD MOTOR COMPANY (2005)

C2.5

C2.5



PRELIMINARY
NOT FOR CONSTRUCTION

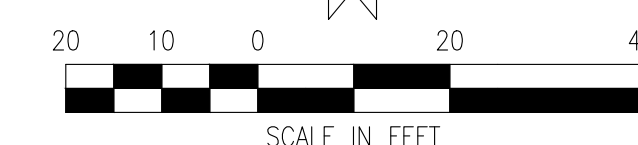

SCALE IN FFF



PRELIMINARY
NOT FOR CONSTRUCTION



BUILDING SITE CODE:	XXX
FORD PROJECT NUMBER:	XXXX-X



PROJECT NUMBER: WAB2004 01H

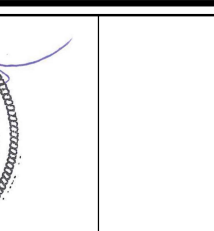

THIS DRAWING HAS BEEN PREPARED BY OR ON BEHALF OF FORD MOTOR COMPANY. FORD MOTOR COMPANY RETAINS ALL COMMON LAW, STATUTORY AND OTHER RESERVED RIGHTS INCLUDING COPYRIGHTS. THIS DRAWING SHALL NOT BE USED FOR ANY PURPOSE OTHER THAN PERFORMING SERVICES DIRECTLY OR INDIRECTLY TO FORD MOTOR COMPANY. WITHOUT THE EXPRESSED WRITTEN PERMISSION OF FORD MOTOR COMPANY. UNAUTHORIZED USE, COPYING OR MODIFICATION, INCLUDING THE REMOVAL OF THIS NOTICE, MAY CONSTITUTE A VIOLATION OF CIVIL OR CRIMINAL LAWS ENFORCEABLE BY FORD OR GOVERNMENTAL AGENCIES.

COPYRIGHT © FORD MOTOR COMPANY (2016)

04/25/2023	• SITE PLAN APPROVAL
04/14/2023	• SITE PLAN PRE APPLICATION

DATE	ISSUED FOR
------	------------

IN CHARGE: _____ | CIESIELE SKI _____

DRAWN BY: M KAMINSKI

DESIGNED BY: S DODSON

CHECKED BY: B NARTKE

SHEET TITLE

OVERALL UTILITY PLAN

OVERALL STUDENT LEARN

FORD DWG NO. _____ REV. # _____

SHEET NUMBER

C3.0

PRINTED COPIES ARE UNCLASSIFIED

[Downloaded from ascelibrary.org by University of California - San Diego on 06/11/18. Copyright ASCE. For personal use; all rights reserved.](#)







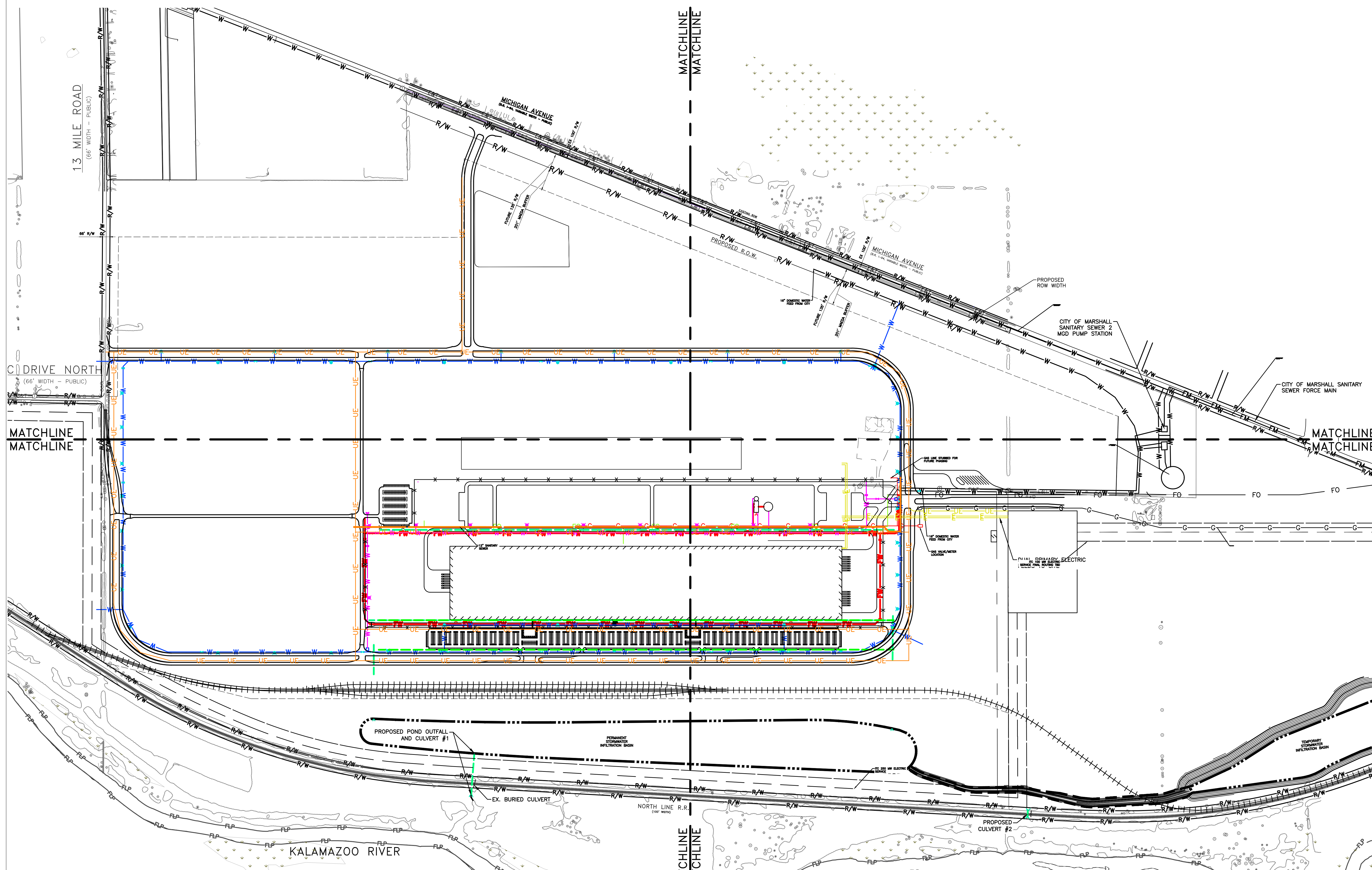

TABLE 1

[illegible]

OF DATE: 10/10/00 09:40 AM



LEGEND (SHEETS C3.0-C3.4)

SANITARY SEWER LINE		
STORM SEWER LINE		
DOMESTIC WATER LINE		DOMESTIC WATER VALVE
FORD DOMESTIC WATER LINE		FORD DOMESTIC WATER VALVE
FIREWATER LINE		FIREWATER VALVE
UNDERGROUND ELECTRIC		
NATURAL GAS		
OVERHEAD ELECTRIC		
FIBER OPTIC		

NOTE:
NON-COLORED UTILITIES SHOWN
OFFSITE PROPOSED IMPROVEMENTS

NOTE:
NON-COLORED UTILITIES SHOWN FOR
OFFSITE PROPOSED IMPROVEMENTS



PRELIMINARY
NOT FOR CONSTRUCTION

400 200 0 400 800

SCALE IN FEET



25251 Northline Rd
Taylor, MI 48180
734.947.9700
www.wadetrtrim.com

25251 Northline Rd
Taylor, MI 48180
734.947.9700
www.wadetrims.com

STATE OF MICHIGAN
ERICH VINCENT SMITH
ENGINEER
NO. 45887
LICENSED PROFESSIONAL ENGINEER

THIS DRAWING HAS BEEN PREPARED BY OR ON BEHALF OF FORD MOTOR COMPANY. FORD MOTOR COMPANY RETAINS ALL COMMON LAW, STATUTORY AND OTHER RESERVED RIGHTS INCLUDING COPYRIGHTS. THIS DRAWING SHALL NOT BE USED FOR ANY PURPOSE OTHER THAN PERFORMING SERVICES DIRECTLY OR INDIRECTLY TO FORD MOTOR COMPANY, WITHOUT THE EXPRESSED WRITTEN PERMISSION OF FORD MOTOR COMPANY. UNAUTHORIZED USE, COPYING OR MODIFICATION, INCLUDING THE REMOVAL OF THIS NOTICE, MAY CONSTITUTE A VIOLATION OF CIVIL OR CRIMINAL LAWS ENFORCEABLE BY FORD OR GOVERNMENTAL AGENCIES.

COPYRIGHT © FORD MOTOR COMPANY 120

DATE ISSUED FOR

SHEET TITLE

UTILITY PLAN (2 OF 4)

FORD DWG NO. _____ REV. # _____

SHEET NUMBER _____

C3.2



PRELIMINARY
NOT FOR CONSTRUCTION

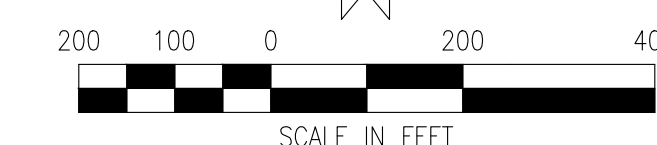

SCALE IN FEET

[illegible]

TABLE 1

INDICATED BY THE FOLLOWING

OF DATE: 10/10/00 09:41 AM

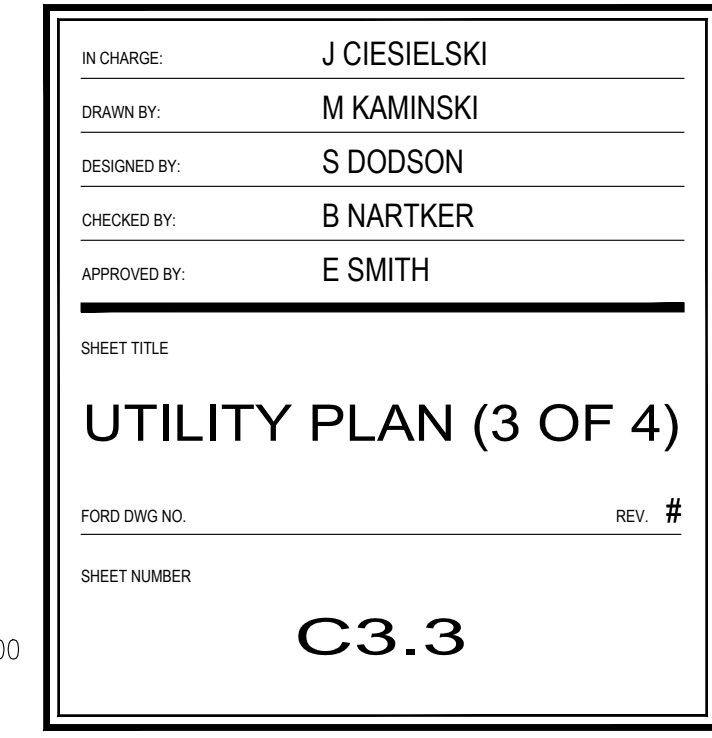

KALAMAZOO RIVER

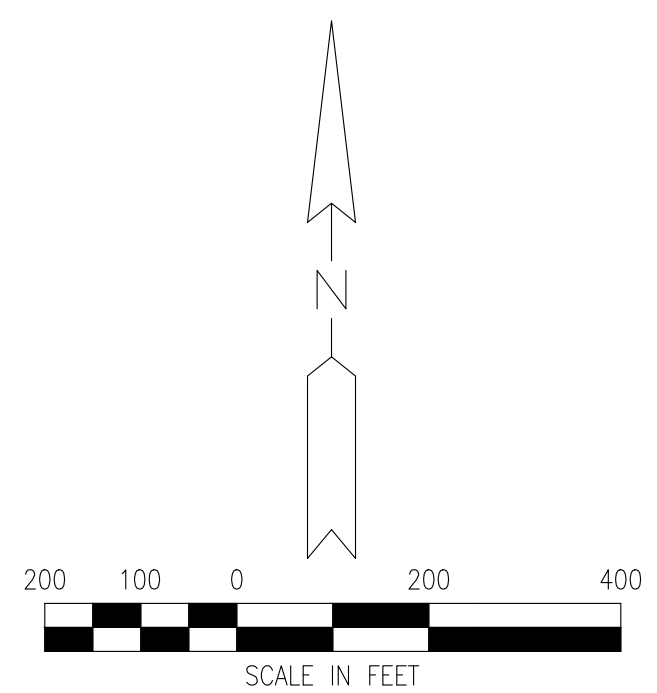

PRINTED COPIES ARE UNCONTROLLED

MATCHLINE SEE SHEET C3.3

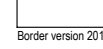

PRODUCTION
BUILDING
2,326,000 SF
FFE = 920.50

TEMPORARY
STORMWATER
INFILTRATION BASIN

PROPOSED CULVERT #2

EX. BURIED
CULVERT

TEMPORARY DRAINAGE SWALE TO
ON-SITE INFILTRATION BASIN

- 16" DOMESTIC WATER
FEED FROM CITY
- GAS VALVE/METER
LOCATION
- CITY WATER METER LOCATION

ITC 100 MW ELECTRIC
SERVICE FINAL ROUTING TBD

NATURAL GAS LINE



C3 4

C3.4

AGGREGATE [MDOT 6A] (CROSS SECTION)	
CONCRETE	
CONSTRUCTION ENTRANCE	
SAND	
WETLAND	
PAVEMENT	
MANICURED GRASS LAWN	
NATIVE NO-MOW SEEDED AREA	
EXISTING GROUND	

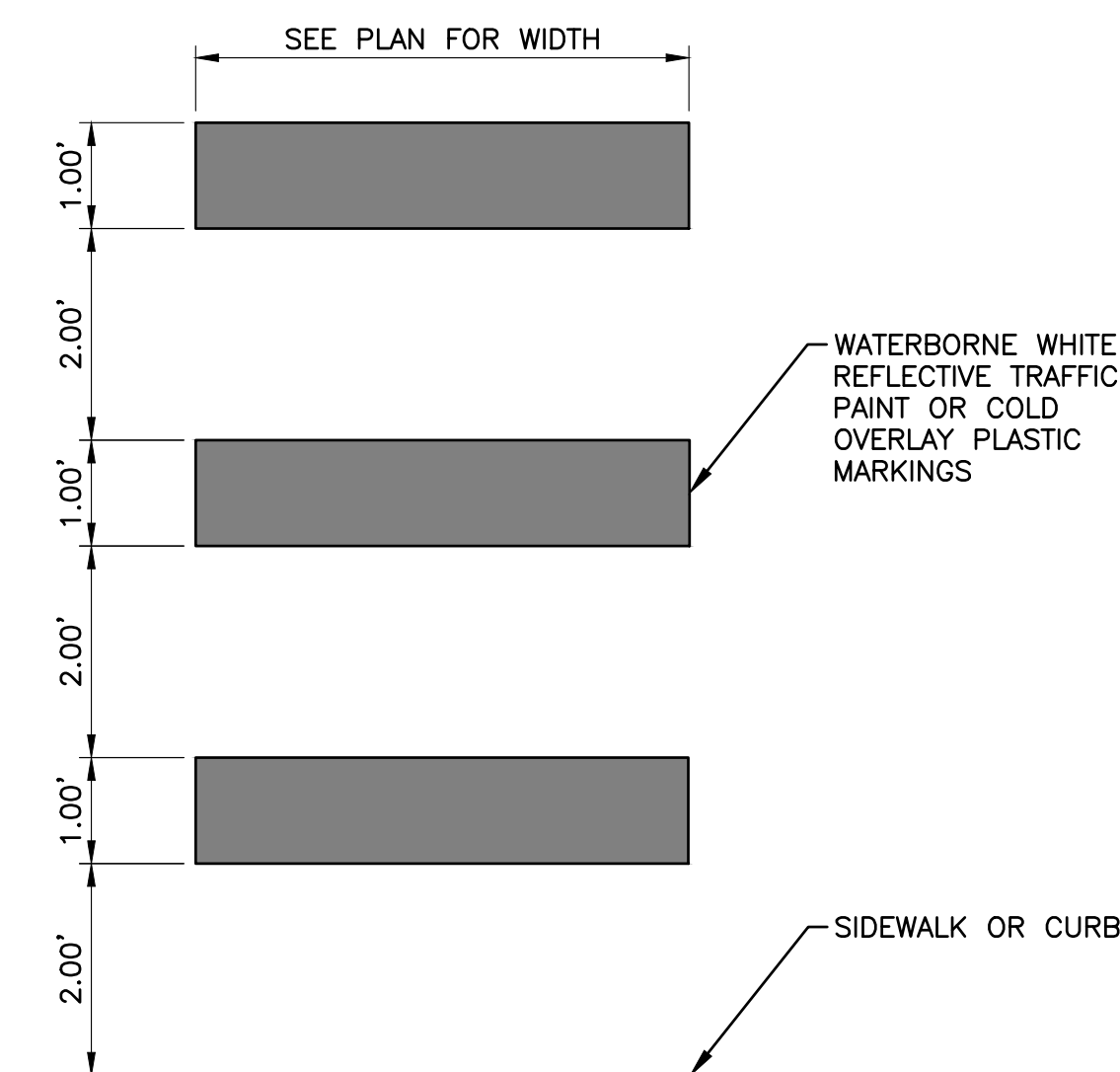

CROSSWALK DETAIL
NTS

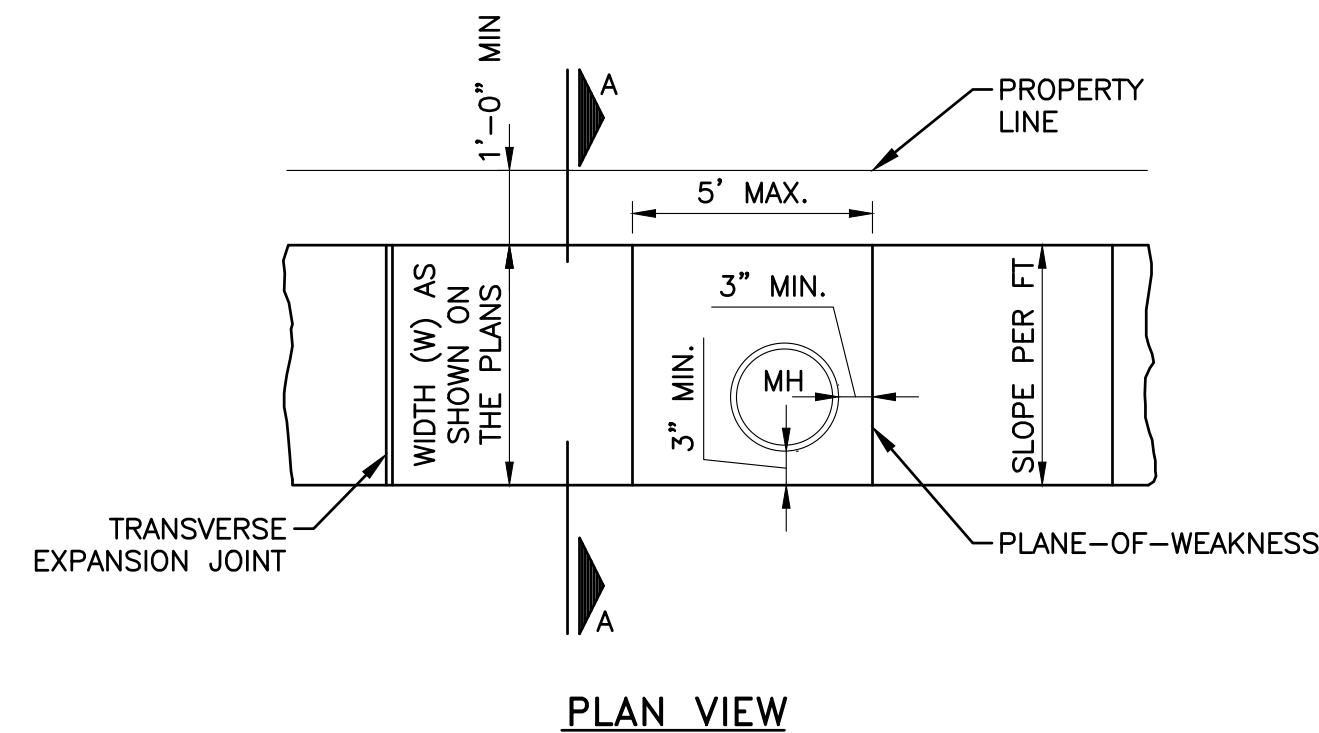

SIDEWALK PLAN DETAIL
NTS

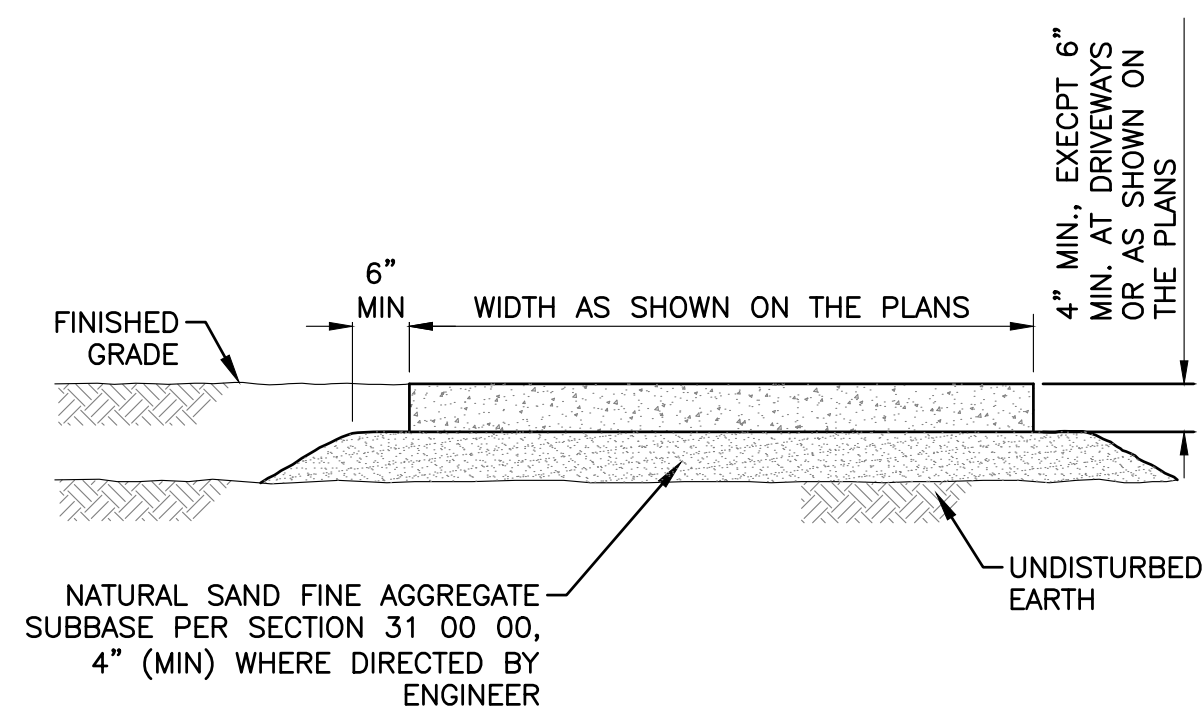

SECTION A-A
TYPICAL SIDEWALK DETAIL
NTS

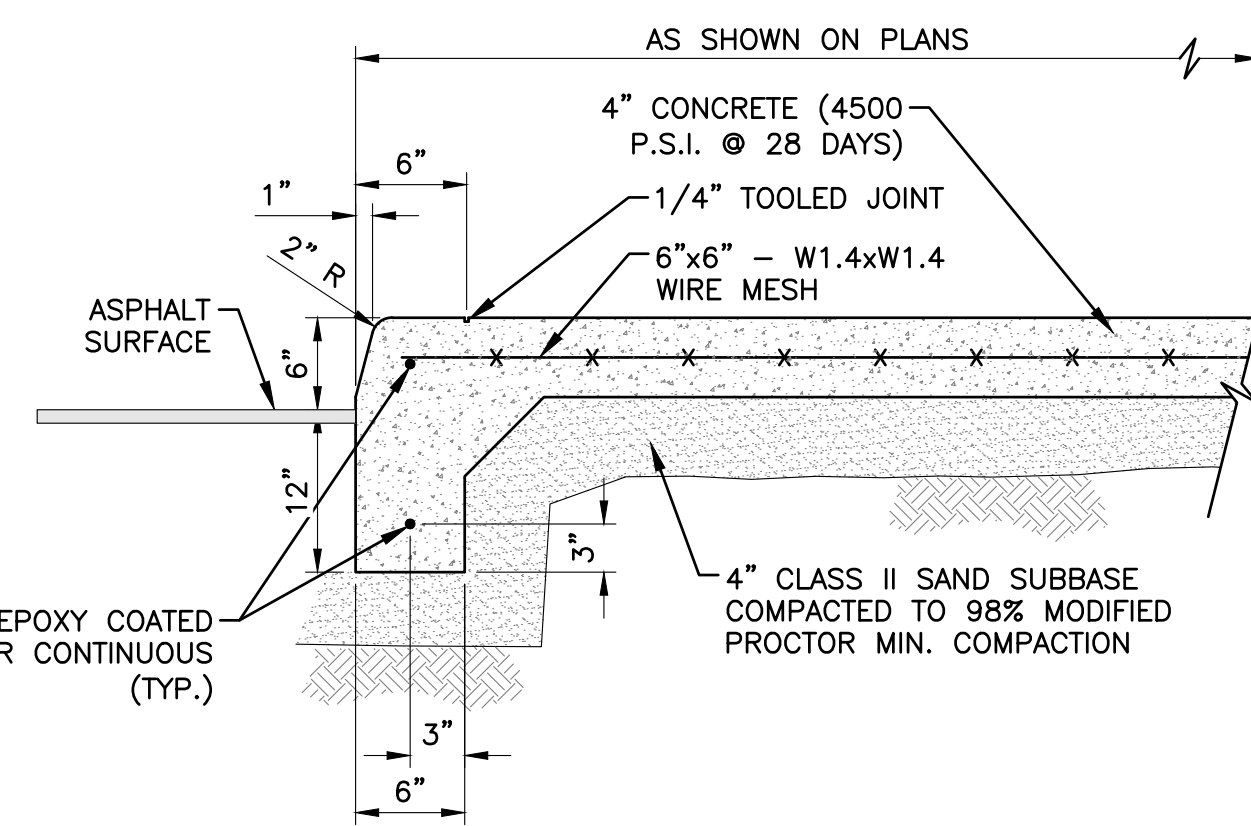

CONCRETE WALK W/ THICKENED EDGE DETAIL
NTS

1. ONE-HALF INCH TRANSVERSE EXPANSION JOINTS SHALL BE PLACED THROUGH THE SIDEWALK AT UNIFORM INTERVALS OF NOT MORE THAN 1 EVERY 50 FEET. A ONE-INCH EXPANSION JOINTS SHALL ALSO BE PLACED BETWEEN THE SIDEWALK AND ABUTTING PARALLEL CURB, BUILDINGS, RIGID STRUCTURES, CONCRETE DRIVES AND CONCRETE DRIVE APPROACHES. ONE-INCH EXPANSION JOINTS SHALL ALSO BE PLACED BETWEEN SIDEWALK RAMPS AND BACK OF CURB.

1. SIDEWALK RAMP CONSTRUCTION AND DETECTABLE WARNING DETAILS SHALL BE IN ACCORDANCE WITH MDOT STANDARD PLAN (OR SPECIAL DETAILS) R-28-SERIES.
2. SIDEWALK RAMPS AS CALLED FOR ON THE PLANS SHALL HAVE DETECTABLE WARNINGS THAT CONTRAST VISUALLY WITH THE ADJACENT WALKING SURFACE.
3. DETECTABLE WARNING SHALL CONSIST OF 2'x2' CAST IRON DETECTABLE WARNING PLATES (QUICK CONNECT OR BOLTED PLATES) BY NEENAH FOUNDRY OR EAST JORDAN IRON WORKS "DURALAST" - NON PAINTED.



Know what's **below**.
Call before you dig.

PRELIMINARY
NOT FOR CONSTRUCTION

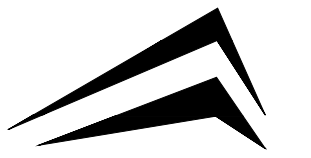

FORDLAND

17000 ROTUNDA DR, 1ST FLOOR SOUTH
DEARBORN, MICHIGAN 48120-1168
USA



BUILDING SITE CODE:	XXX
FORD PROJECT NUMBER:	XXXX-XX



25251 Northline Rd.
Taylor, MI 48180
734.947.9700
www.wadetrim.com

PROJECT NUMBER: WAB2004 01H

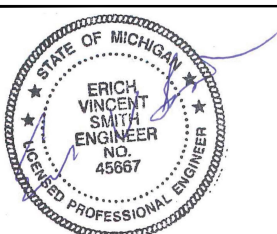

THIS DRAWING HAS BEEN PREPARED BY OR ON BEHALF OF FORD MOTOR COMPANY. FORD MOTOR COMPANY RETAINS ALL COMMON LAW, STATUTORY AND OTHER RESERVED RIGHTS, INCLUDING COPYRIGHTS. THIS DRAWING SHALL NOT BE USED FOR ANY PURPOSE OTHER THAN PERFORMING SERVICES DIRECTLY OR INDIRECTLY TO FORD MOTOR COMPANY, WITHOUT THE EXPRESSED WRITTEN PERMISSION OF FORD MOTOR COMPANY. UNAUTHORIZED USE, COPYING OR MODIFICATION, INCLUDING THE REMOVAL OF THIS NOTE, MAY CONSTITUTE A VIOLATION OF CIVIL OR CRIMINAL LAWS ENFORCEABLE BY FORD OR GOVERNMENTAL AGENCIES.

COPYRIGHT © FORD MOTOR COMPANY (2009)

04/25/2023	• SITE PLAN APPROVAL
04/14/2023	• SITE PLAN PRE APPLICATION

DATE	ISSUED FOR
------	------------

IN CHARGE:	J CIESIELSKI
DRAWN BY:	M KAMINSKI
DESIGNED BY:	S DODSON
CHECKED BY:	B NARTKER
APPROVED BY:	E SMITH

SHEET TITLE

SIDEWALK DETAILS

FORD DWG NO.

V. #

C4.1

C:\Users\rcarnel\DCI\ACCDocs\Wade Trim\FRD2011-05F Project Hickory\Project Files\01 Design\Civil 3D\Phase 01\Plan Sheets\SPA\20000000-001-CU-DTLS-A22-WADE.dwg

CANNA, RYAN

SAVE DATE: 4/25/2023 10:38:42 AM

PLOT DATE: 4/25/2023 3:54 PM

UNCONTROLLED COPIES ARE UNCONTROLLED

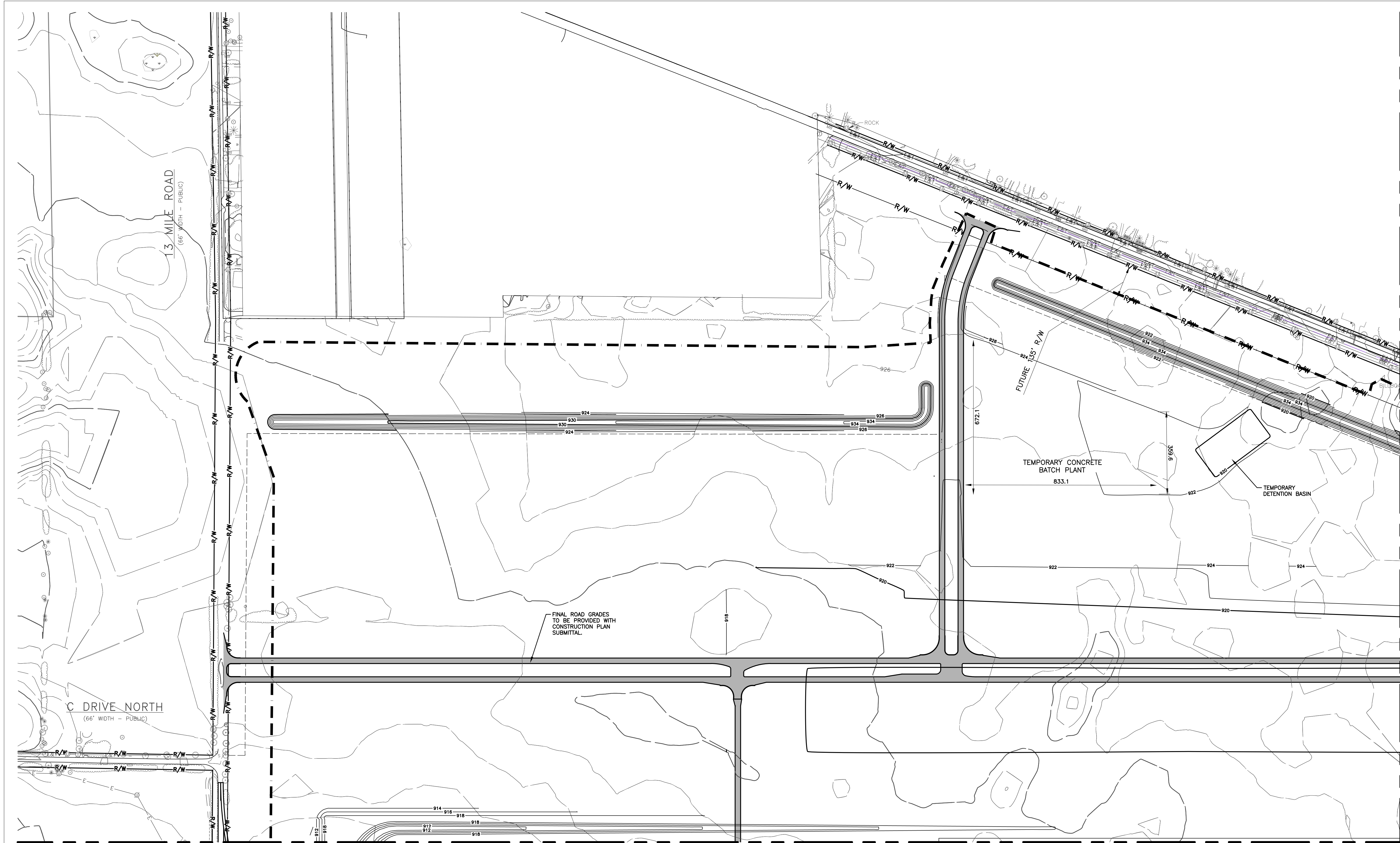

17000 ROTUNDA DR, 1ST FLOOR SOUTH
DEARBORN, MICHIGAN 48120-1168
USA

BUILDING SITE CODE: XXXX
FORD PROJECT NUMBER: XXXX-XX

25251 Northline Rd.
Taylor, MI 48180
734.947.9700
www.wadetrim.com

PROJECT NUMBER: WAB2004 01H



THIS DRAWING HAS BEEN PREPARED BY OR ON BEHALF OF FORD MOTOR COMPANY. FORD MOTOR COMPANY RETAINS ALL COMMON LAW, STATUTORY AND OTHER RESERVED RIGHTS, INCLUDING COPYRIGHTS. THIS DRAWING SHALL NOT BE USED FOR ANY PURPOSE OTHER THAN PERFORMING SERVICES DIRECTLY OR INDIRECTLY TO FORD MOTOR COMPANY, WITHOUT THE EXPRESSED WRITTEN PERMISSION OF FORD MOTOR COMPANY. UNAUTHORIZED USE, COPYING OR MODIFICATION, INCLUDING THE REMOVAL OF THIS NOTE, MAY CONSTITUTE A VIOLATION OF CIVIL OR CRIMINAL LAWS ENFORCEABLE BY FORD OR GOVERNMENTAL AGENCIES.
COPYRIGHT © FORD MOTOR COMPANY (2009)

- 04/25/2023

• SITE PLAN APPROVAL
- 04/14/2023

• SITE PLAN PRE APPLICATION

DATE ISSUED FOR

IN CHARGE: J CIESIELSKI
DRAWN BY: M KAMINSKI
DESIGNED BY: S DODSON
CHECKED BY: B NARTKER
APPROVED BY: E SMITH

SHEET TITLE
GRADING PLAN (1 OF 4)

FORD DWG NO. REV #
SHEET NUMBER

C5.1



Know what's below.
Call before you dig.

PRELIMINARY
NOT FOR CONSTRUCTION

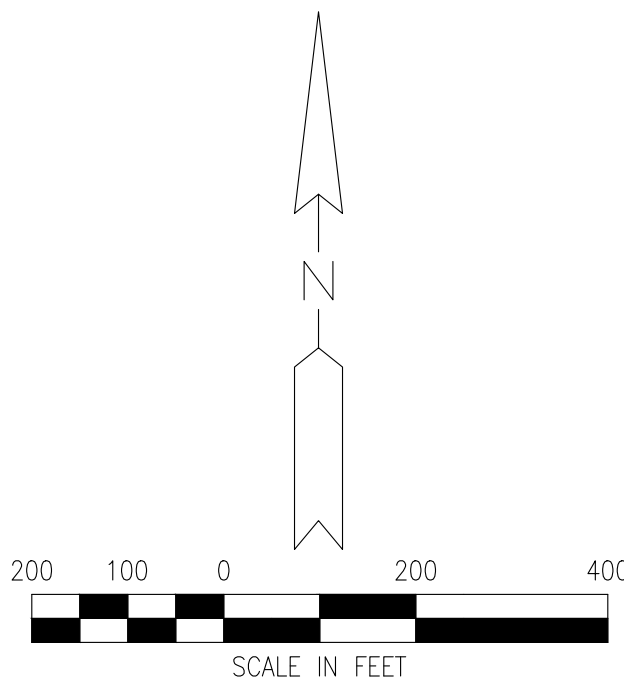

MATCHLINE SEE SHEET C5.1

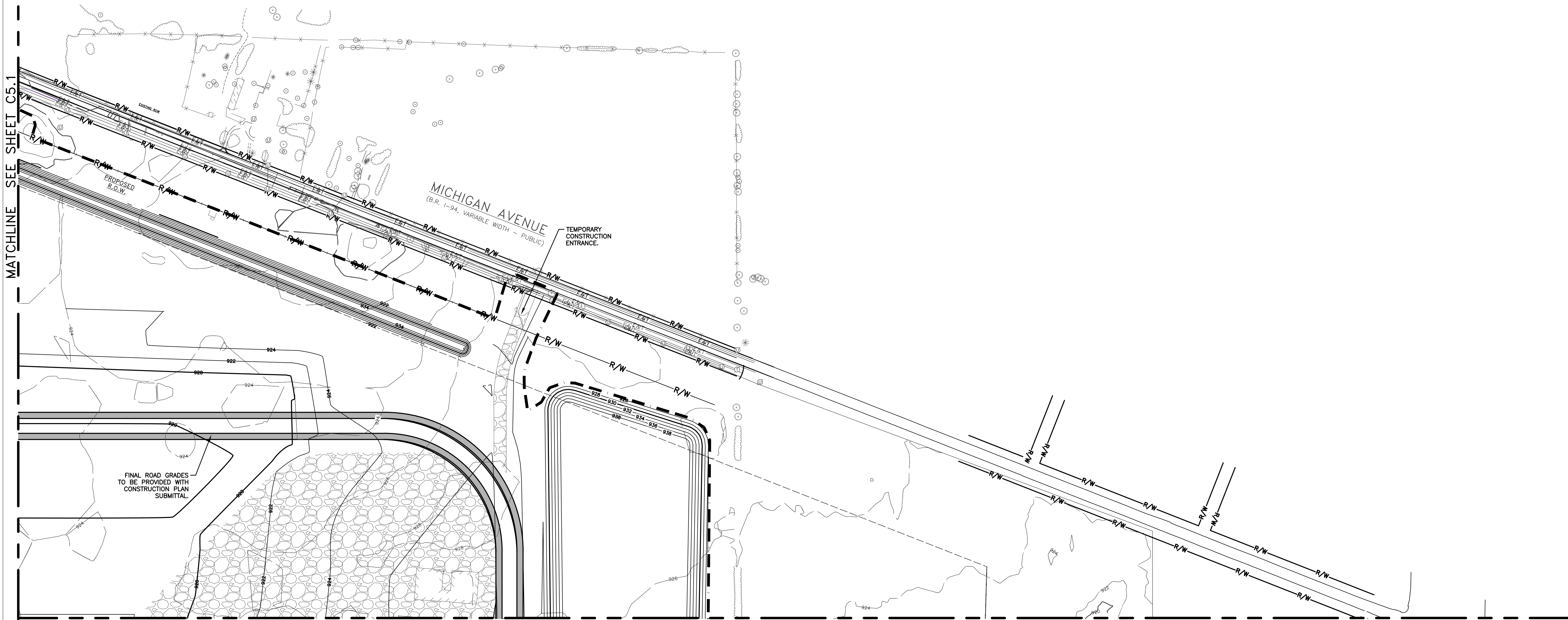

BUILDING SITE CODE: XXX
RD PROJECT NUMBER: XXXX-XX



**WADE
TRIM**

25251 Northline Rd.
Taylor, MI 48180
734.947.9700
www.wadetrim.com

PROJECT NUMBER: WAB2004 01H

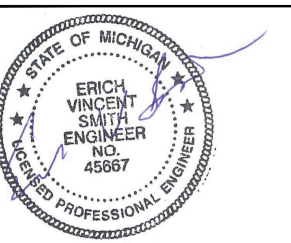

DRAWING HAS BEEN PREPARED BY OR ON BEHALF OF FORD MOTOR COMPANY. FORD MOTOR COMPANY RETAINS ALL COMMON LAW, STATUTORY AND OTHER RESERVED RIGHTS, INCLUDING COPYRIGHTS. THIS DRAWING SHALL NOT BE USED FOR ANY PURPOSE OTHER THAN PERFORMING SERVICES DIRECTLY OR INDIRECTLY TO FORD MOTOR COMPANY, WITHOUT THE EXPRESSED WRITTEN PERMISSION OF FORD MOTOR COMPANY. ANY UNAUTHORIZED USE, COPYING OR MODIFICATION, INCLUDING THE REMOVAL OF THIS NOTE, MAY CONSTITUTE A VIOLATION OF CIVIL OR CRIMINAL LAWS ENFORCEABLE BY FORD OR GOVERNMENTAL AGENCIES.

Copyright © Ford Motor Company (2019)

- [illegible]

- | | |
|-----------|-----------------------------|
| 1/25/2023 | • SITE PLAN APPROVAL |
| 1/14/2023 | • SITE PLAN PRE APPLICATION |

TE ISSUED FOR

CHARGE:	J CIESIELSKI
CAWEN BY:	M KAMINSKI
SIGNED BY:	S DODSON
CHECKED BY:	B NARTKER
PROVED BY:	E SMITH

GRADING PLAN (3 OF 4)

RD DWG NO. _____ REV. # _____

SHEET NUMBER _____

C5.3

PRELIMINARY
NOT FOR CONSTRUCTION

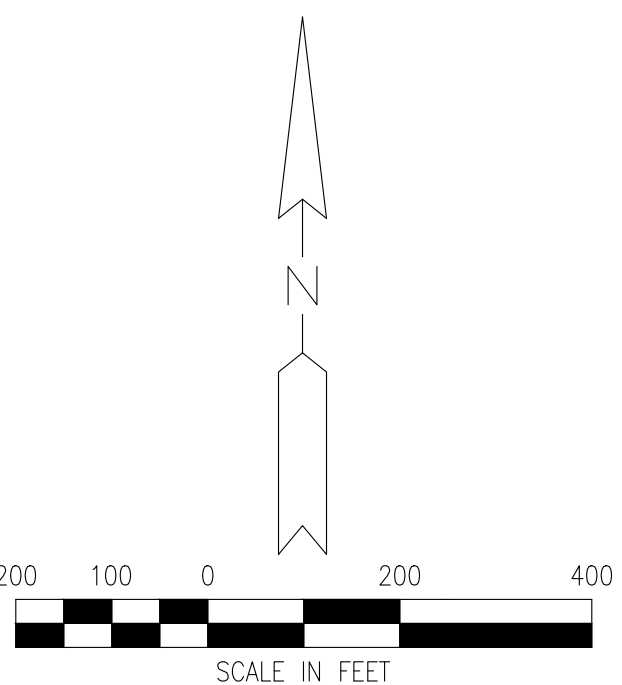

350.000000 876 UNOCONTROLL CO.

MATCHLINE SEE SHEET C5.2

FINAL ROAD GRADES
TO BE PROVIDED WITH
CONSTRUCTION PLAN
SUBMITTAL.

PRODUCTION BUILDING
2,326,000 SF
FEE=920.50

PERMANENT PARKING AREA
± 1600 SPACES

STORMWATER
FILTRATION BASIN
1,675,204 SF
FLOOR ELEV.
898.50

NORTH LINE R.R.
(100' WIDTH)

KALAMAZOO RIVER



Know what's **below**.
Call before you dig.

Revised version 08/14/05

MATCHLINE SEE SHEET C5.3

PRODUCTION BUILDING
2,326,000 SF
FEE=920.50

PERMANENT PARKING AREA
± 1600 SPACES

PERMANENT
STORMWATER
INFILTRATION BASIN

FINAL ROAD GRADES
TO BE PROVIDED WITH
CONSTRUCTION PLAN
SUBMITTAL.

TEMPORARY DRAINAGE SWALL
TO OFF-SITE INFILTRATION
BASIN.

TEMP. STORMWATER
INFILTRATION BASIN
729,286 SF
FLOOR ELEV.
890.75



FORDLAND

17000 ROTUNDA DR, 1ST FLOOR SOUTH
DEARBORN, MICHIGAN 48120-1168
USA



BUILDING SITE CODE: XXX
FORD PROJECT NUMBER: XXXX-XX

 **WADE
TRIM** 25251 Northline Rd.
Taylor, MI 48180
734.947.9700
www.wadetrिम.com

PROJECT NUMBER: WAB2004 01H



THIS DRAWING HAS BEEN PREPARED BY OR ON BEHALF OF FORD MOTOR COMPANY. FORD MOTOR COMPANY RETAINS ALL COMMON LAW, STATUTORY AND OTHER RESERVED RIGHTS INCLUDING COPYRIGHTS. THIS DRAWING SHALL NOT BE USED FOR ANY PURPOSE OTHER THAN PERFORMING SERVICES DIRECTLY OR INDIRECTLY TO FORD MOTOR COMPANY, WITHOUT THE EXPRESSED WRITTEN PERMISSION OF FORD MOTOR COMPANY. UNAUTHORIZED USE, COPYING OR MODIFICATION, INCLUDING THE REMOVAL OF THIS NOTE MAY CONSTITUTE A VIOLATION OF CIVIL OR CRIMINAL LAWS ENFORCEABLE BY FORD OR GOVERNMENTAL AGENCIES.

COPYRIGHT © FORD MOTOR COMPANY (2009)

[illegible]

04/25/2023	• SITE PLAN APPROVAL
04/14/2023	• SITE PLAN PRE APPLICATION

DATE	ISSUED FOR
IN CHARGE:	J CIESIELSKI
DRAWN BY:	M KAMINSKI
DESIGNED BY:	S DODSON
CHECKED BY:	B NARTKER
APPROVED BY:	E SMITH

GRADING PLAN (4 OF 4)

FOR Dwg NO.	REV.	#
<hr/>		
SHEET NUMBER		
C5.4		



Know what's **below**.
Call before you dig.

PRELIMINARY
NOT FOR CONSTRUCTION

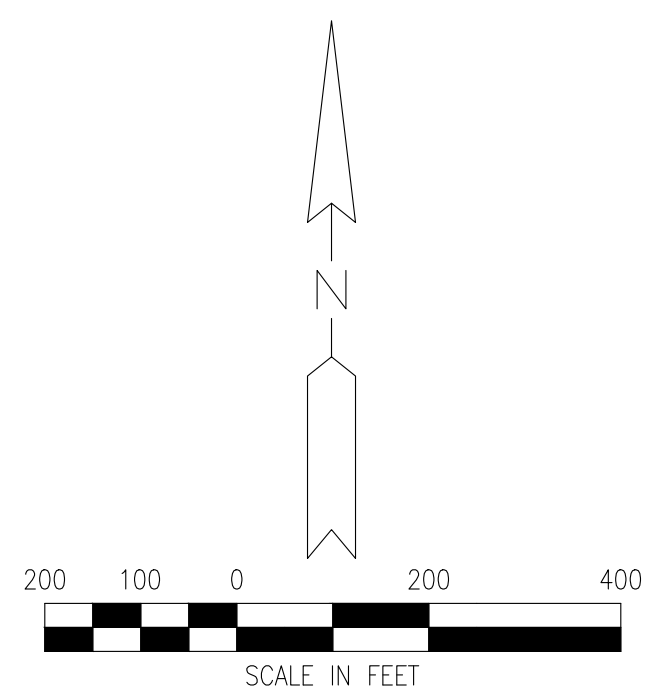

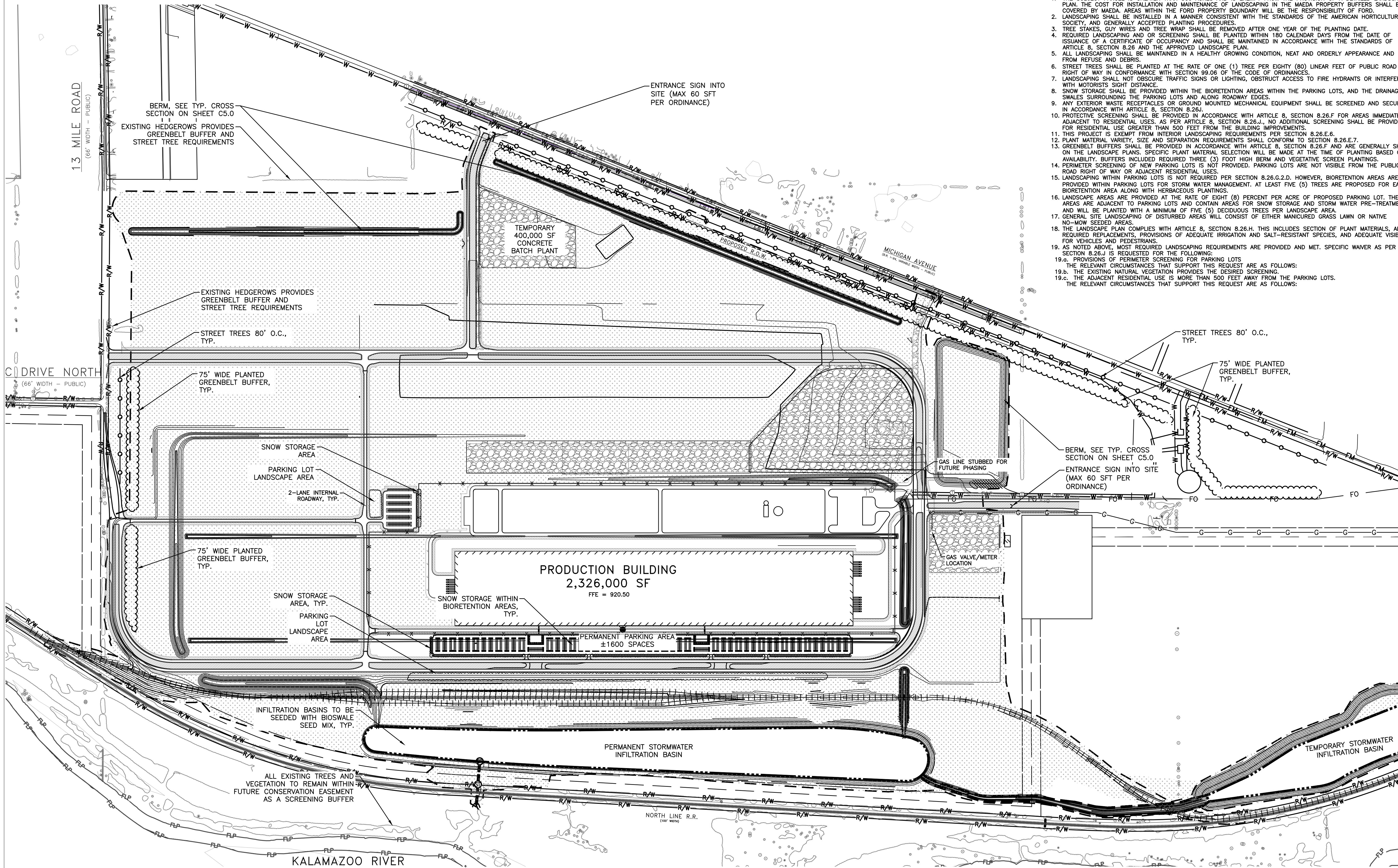

OVERALL LANDSCAPE PLAN

LANDSCAPE SEEDING LEGEND

MANICURED GRASS LAWN

NATIVE NO-MOW SEEDDED AREA

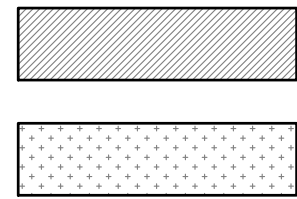

PRELIMINARY
NOT FOR CONSTRUCTION

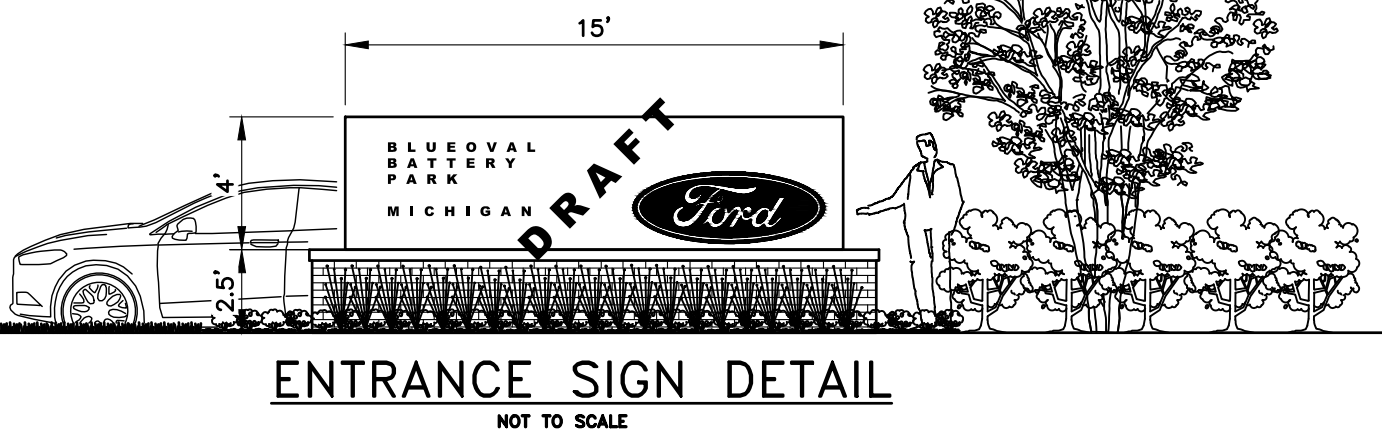
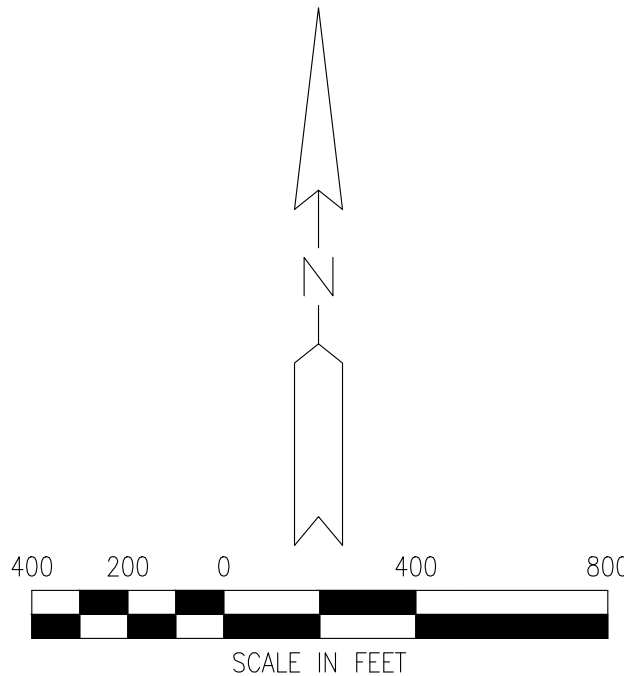

LANDSCAPE REQUIREMENTS:

1. THE SUBJECT PARCEL IS GREATER THAN 500 ACRES AND IS EXEMPT FROM THE PROVISION OF A DETAILED LANDSCAPE PLAN. THE COST FOR INSTALLATION AND MAINTENANCE OF LANDSCAPING IN THE MAEDA PROPERTY BUFFERS SHALL BE COVERED BY MAEDA. AREAS WITHIN THE FORD PROPERTY BOUNDARY WILL BE THE RESPONSIBILITY OF FORD.
2. LANDSCAPING SHALL BE INSTALLED IN A MANNER CONSISTENT WITH THE STANDARDS OF THE AMERICAN HORTICULTURAL SOCIETY, AND GENERALLY ACCEPTED PLANTING PROCEDURES.
3. TREE STAKES, GUY WIRES AND TREE WRAP SHALL BE REMOVED AFTER ONE YEAR OF THE PLANTING DATE.
4. REQUIRED LANDSCAPING AND OR SCREENING SHALL BE PLANTED WITHIN 180 CALENDAR DAYS FROM THE DATE OF ISSUANCE OF A CERTIFICATE OF OCCUPANCY AND SHALL BE MAINTAINED IN ACCORDANCE WITH THE STANDARDS OF ARTICLE 8, SECTION 8.26 AND THE APPROVED LANDSCAPE PLAN.
5. ALL LANDSCAPING SHALL BE MAINTAINED IN A HEALTHY GROWING CONDITION, NEAT AND ORDERLY APPEARANCE AND FREE FROM REFUSE AND DEBRIS.
6. STREET TREES SHALL BE PLANTED AT THE RATE OF ONE (1) TREE PER EIGHTY (80) LINEAR FEET OF PUBLIC ROAD RIGHT OF WAY IN CONFORMANCE WITH SECTION 99.06 OF THE CODE OF ORDINANCES.
7. LANDSCAPING SHALL NOT OBSCURE TRAFFIC SIGNS OR LIGHTING, OBSTRUCT ACCESS TO FIRE HYDRANTS OR INTERFERE WITH MOTORISTS SIGHT DISTANCE.
8. SNOW STORAGE SHALL BE PROVIDED WITHIN THE BIORETENTION AREAS WITHIN THE PARKING LOTS, AND THE DRAINAGE SWALES SURROUNDING THE PARKING LOTS AND ALONG ROADWAY EDGES.
9. ANY EXTERIOR WASTE RECEPTACLES OR GROUND MOUNTED MECHANICAL EQUIPMENT SHALL BE SCREENED AND SECURED IN ACCORDANCE WITH ARTICLE 8, SECTION 8.26J.
10. PROTECTIVE SCREENING SHALL BE PROVIDED IN ACCORDANCE WITH ARTICLE 8, SECTION 8.26.F FOR AREAS IMMEDIATELY ADJACENT TO RESIDENTIAL USES, AS PER ARTICLE 8, SECTION 8.26.J., NO ADDITIONAL SCREENING SHALL BE PROVIDED FOR RESIDENTIAL USE GREATER THAN 500 FEET FROM THE BUILDING IMPROVEMENTS.
11. THIS PROJECT IS EXEMPT FROM INTERIOR LANDSCAPING REQUIREMENTS PER SECTION 8.26.E.6.
12. PLANT MATERIAL VARIETY, SIZE AND SEPARATION REQUIREMENTS SHALL CONFORM TO SECTION 8.26.E.7.
13. GREENBELT BUFFERS SHALL BE PROVIDED IN ACCORDANCE WITH ARTICLE 8, SECTION 8.26.F AND ARE GENERALLY SHOWN ON THE LANDSCAPE PLANS. SPECIFIC PLANT MATERIAL SELECTION WILL BE MADE AT THE TIME OF PLANTING BASED ON AVAILABILITY. BUFFERS INCLUDED REQUIRED THREE (3) FOOT HIGH BERM AND VEGETATIVE SCREEN PLANTINGS.
14. PERIMETER SCREENING OF NEW PARKING LOTS IS NOT PROVIDED. PARKING LOTS ARE NOT VISIBLE FROM THE PUBLIC ROAD RIGHT OF WAY OR ADJACENT RESIDENTIAL USES.
15. LANDSCAPING WITHIN PARKING LOTS IS NOT REQUIRED PER SECTION 8.26.G.2.D. HOWEVER, BIORETENTION AREAS ARE PROVIDED WITHIN PARKING LOTS FOR STORM WATER MANAGEMENT. AT LEAST FIVE (5) TREES ARE PROPOSED FOR EACH BIORETENTION AREA ALONG WITH HERBACEOUS PLANTINGS.
16. LANDSCAPE AREAS ARE PROVIDED AT THE RATE OF EIGHT (8) PERCENT PER ACRE OF PROPOSED PARKING LOT. THESE AREAS ARE ADJACENT TO PARKING LOTS AND CONTAIN AREAS FOR SNOW STORAGE AND STORM WATER PRE-TREATMENT AND WILL BE PLANTED WITH A MINIMUM OF FIVE (5) DECIDUOUS TREES PER LANDSCAPE AREA.
17. GENERAL SITE LANDSCAPING OF DISTURBED AREAS WILL CONSIST OF EITHER MANICURED GRASS LAWN OR NATIVE NO-MOW SEEDDED AREAS.
18. THE LANDSCAPE PLAN COMPLIES WITH ARTICLE 8, SECTION 8.26.H. THIS INCLUDES SECTION OF PLANT MATERIALS, ANY REQUIRED REPLACEMENTS, PROVISIONS OF ADEQUATE IRRIGATION AND SALT-RESISTANT SPECIES, AND ADEQUATE VISIBILITY FOR VEHICLES AND PEDESTRIANS.
19. AS NOTED ABOVE, MOST REQUIRED LANDSCAPING REQUIREMENTS ARE PROVIDED AND MET. SPECIFIC WAIVER AS PER SECTION 8.26.J IS REQUESTED FOR THE FOLLOWING:
19.a. PROVISIONS OF PERIMETER SCREENING FOR PARKING LOTS
THE RELEVANT CIRCUMSTANCES THAT SUPPORT THIS REQUEST ARE AS FOLLOWS:
19.b. THE EXISTING NATURAL VEGETATION PROVIDES THE DESIRED SCREENING.
19.c. THE ADJACENT RESIDENTIAL USE IS MORE THAN 500 FEET AWAY FROM THE PARKING LOTS.
THE RELEVANT CIRCUMSTANCES THAT SUPPORT THIS REQUEST ARE AS FOLLOWS:



BUILDING SITE CODE: XXXX
FORD PROJECT NUMBER: XXXX-XX



PROJECT NUMBER: WAB2004 01H



THIS DRAWING HAS BEEN PREPARED BY OR ON BEHALF OF FORD MOTOR COMPANY. FORD MOTOR COMPANY RETAINS ALL COMMON LAW, STATUTORY AND OTHER RESERVED RIGHTS, INCLUDING COPYRIGHTS. THIS DRAWING SHALL NOT BE USED FOR ANY PURPOSE OTHER THAN PERFORMING SERVICES DIRECTLY OR INDIRECTLY TO FORD MOTOR COMPANY. WITHOUT THE EXPRESSED WRITTEN PERMISSION OF FORD MOTOR COMPANY, UNAUTHORIZED USE, COPYING OR MODIFICATION, INCLUDING THE REMOVAL OF THIS NOTE, MAY CONSTITUTE A VIOLATION OF CIVIL OR CRIMINAL LAWS ENFORCEABLE BY FORD OR GOVERNMENTAL AGENCIES.

COPYRIGHT © FORD MOTOR COMPANY (2009)

04/25/2023 • SITE PLAN APPROVAL
04/14/2023 • SITE PLAN PRE APPLICATION

DATE ISSUED FOR

IN CHARGE: J CIESIELSKI
DRAWN BY: M KAMINSKI
DESIGNED BY: S DODSON
CHECKED BY: B NARTKER
APPROVED BY: E SMITH

SHEET TITLE
OVERALL LANDSCAPE PLAN

FORD DWG NO. REV #
SHEET NUMBER

L1.0



Know what's below.
Call before you dig.



**WADE
TRIM**

25251 Northline Rd
Taylor, MI 48180
734.947.9700
www.wadetrिम.com

25251 Northline Rd
Taylor, MI 48180
734.947.9700
www.wadetrims.com

STATE OF MICHIGAN
SCOOT ARTHUR LAUTZENHEISER
LANDSCAPE ARCHITECT
No. 1543
LICENSED LANDSCAPE ARCHITECT

THIS DRAWING HAS BEEN PREPARED BY OR ON BEHALF OF FORD MOTOR COMPANY. FORD MOTOR COMPANY RETAINS ALL COMMON LAW, STATUTORY AND OTHER RESERVED RIGHTS INCLUDING COPYRIGHTS. THIS DRAWING SHALL NOT BE USED FOR ANY PURPOSE OTHER THAN PERFORMING SERVICES DIRECTLY OR INDIRECTLY TO FORD MOTOR COMPANY, WITHOUT THE EXPRESSED WRITTEN PERMISSION OF FORD MOTOR COMPANY. UNAUTHORIZED USE, COPYING OR MODIFICATION, INCLUDING THE REMOVAL OF THIS NOTICE, MAY CONSTITUTE A VIOLATION OF CIVIL OR CRIMINAL LAWS ENFORCEABLE BY FORD OR GOVERNMENTAL AGENCIES.

COPYRIGHT © FORD MOTOR COMPANY (2009)

04/25/2023	• SITE PLAN APPROVAL
04/14/2023	• SITE PLAN PRE APPLICATION

DATE ISSUED FOR

IN CHARGE:	J CIESIELSKI
DRAWN BY:	M KAMINSKI
DESIGNED BY:	S DODSON
CHECKED BY:	B NARTKER
APPROVED BY:	E SMITH

SHEET TITLE

PARKING LOT LANDSCAPING OVERVIEW

FORD DWG NO. _____ REV. # _____

SHEET NUMBER _____

L1.2



Know what's **below**.
Call before you dig

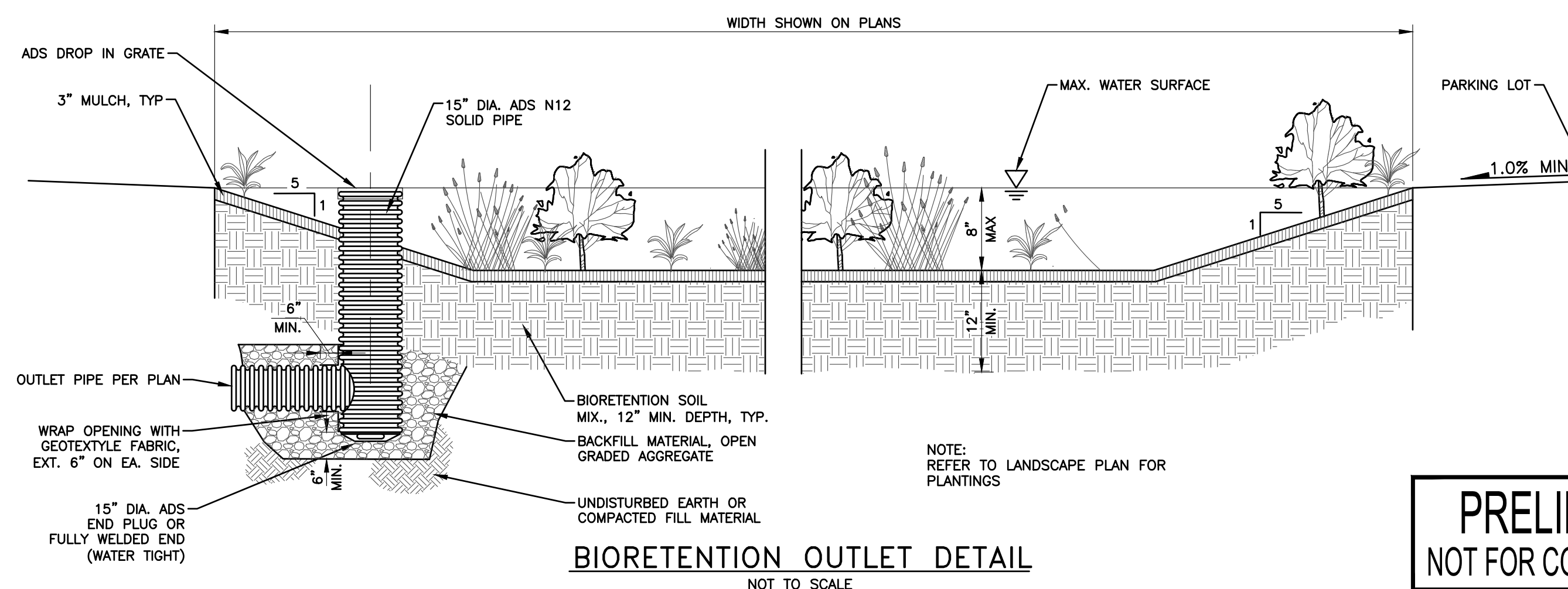
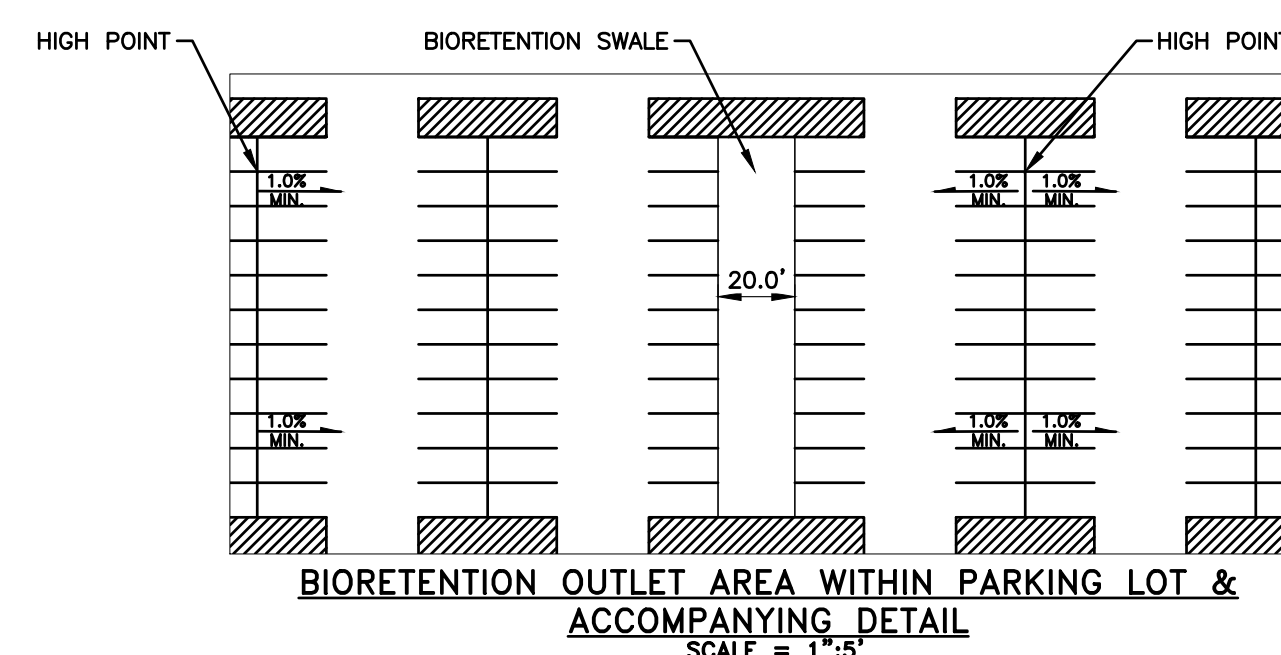

NOTE:
REFER TO LANDSCAPE PLAN FOR
PLANTINGS

PRELIMINARY
NOT FOR CONSTRUCTION

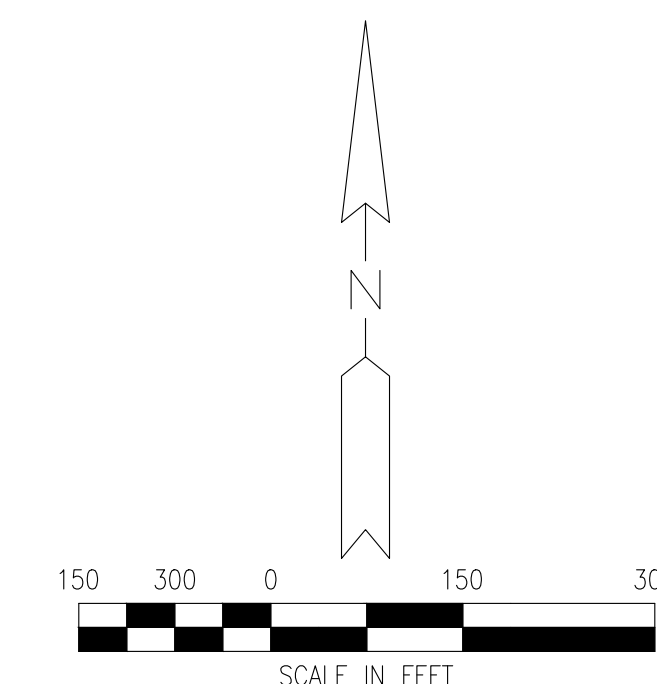



WRAP TREES ONLY UPON THE APPROVAL
OF THE LANDSCAPE ARCHITECT.

1. FOR CONTAINER-GROWN TREES, USE FINGERS OR SMALL HAND TOOLS TO PULL THE ROOTS OUT OF THE OUTER LAYER OF POTTING SOIL; THEN CUT OR PULL APART ANY ROOTS CIRCLING THE PERIMETER OR THE CONTAINER.
2. AFTER DIGGING HOLE, FILL WITH WATER TO CONFIRM THAT WATER DRAINS OUT OF THE SOIL. IF HOLE DOES NOT PERK, DO NOT PLANT TREE. NOTIFY LANDSCAPE ARCHITECT FOR DIRECTION.
3. THOROUGHLY SOAK THE TREE ROOT BALL AND ADJACENT PREPARED SOIL IMMEDIATELY AFTER PLANTING.
4. THE PLANTING PROCESS IS SIMILAR FOR DECIDUOUS AND EVERGREEN TREES.

NOT TO SCALE

TREE STAKING DETAIL – 1.5 IN. CALIPER OR LESS

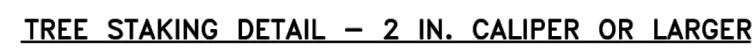

PRELIMINARY
NOT FOR CONSTRUCTION

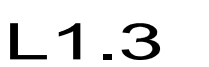

PLOT DATE: 4/25/2023 3:57 PM

UNCONTROLLED COPIES ARE UNCONTROLLED

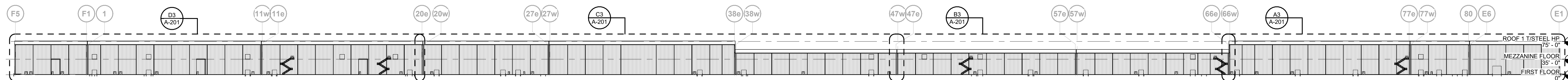

E3
A-110
NORTH ELEVATION COMPOSITE
SCALE: 1" = 100'-0"

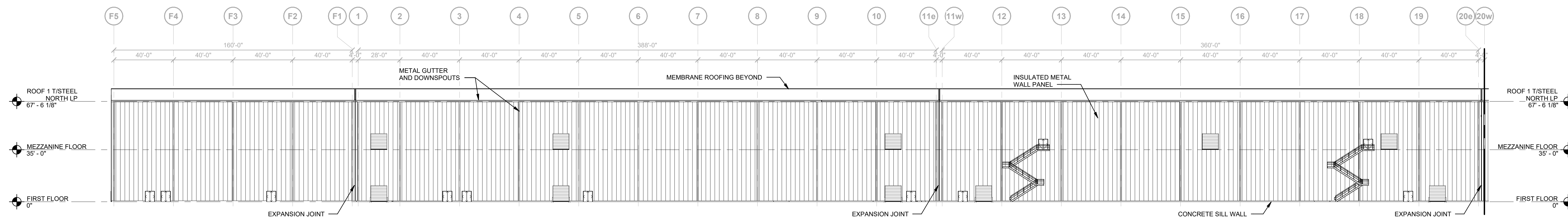

D3
A-201
PARTIAL NORTH ELEVATION
SCALE: 1/32" = 1'-0"

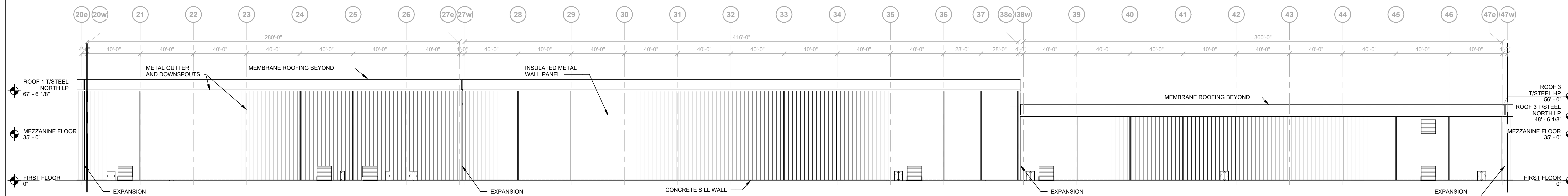

C3
A-201
PARTIAL NORTH ELEVATION
SCALE: 1/32" = 1'-0"

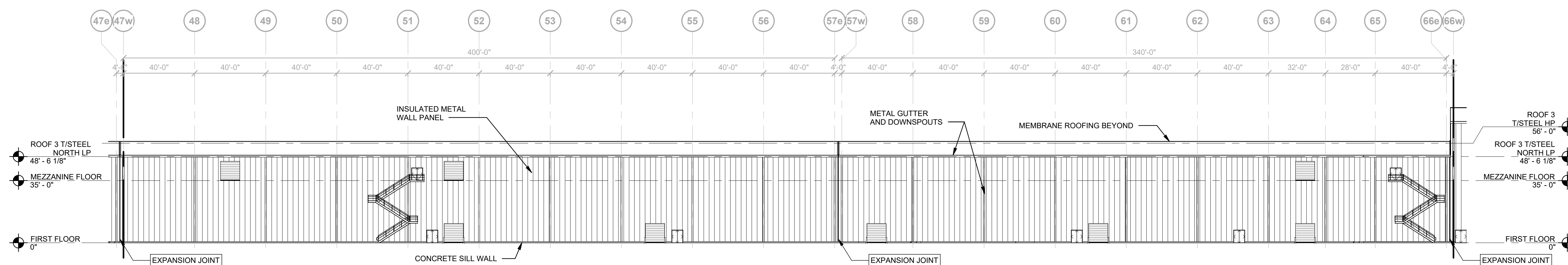

B3
A-201
PARTIAL NORTH ELEVATION
SCALE: 1/32" = 1'-0"

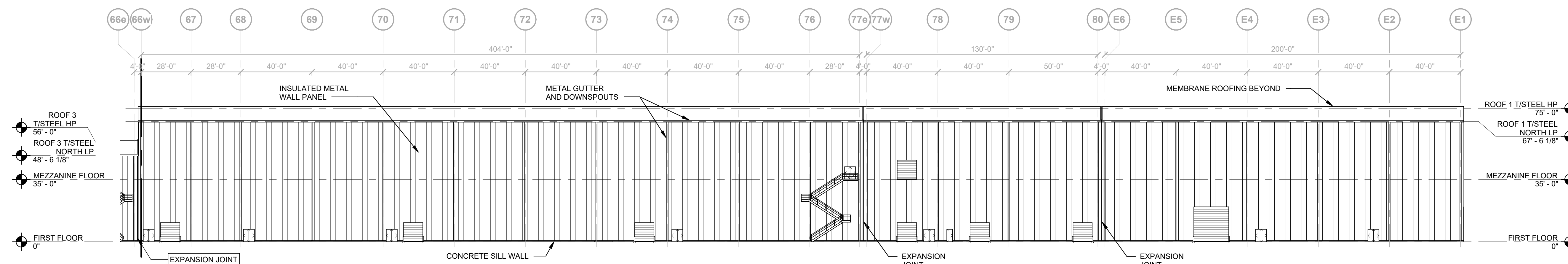

A3
A-201
PARTIAL NORTH ELEVATION
SCALE: 1/32" = 1'-0"

04-25-2023 SITE PLAN REVIEW
DATE ISSUED FOR

AE TEAM INFORMATION
IN CHARGE: **J. HEIDT**
DRAWN BY: **P. KOHLER**
DESIGNED BY: **A. GARZA**
CHECKED BY: **J. BREault**
APPROVED BY: **J. HEIDT**
AE PROJECT NUMBER: **021-01658-00**
SHEET TITLE
EXTERIOR ELEVATIONS - NORTH
SHEET NUMBER BATT-001
A-201

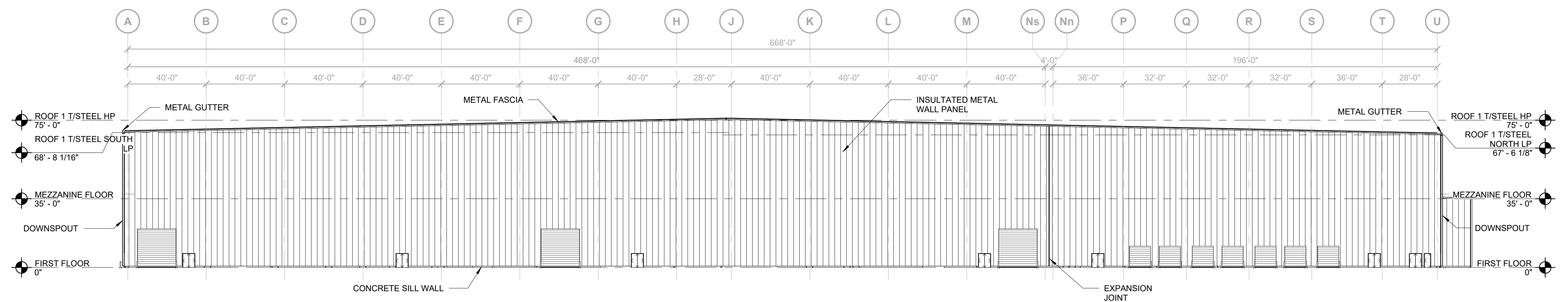

D3
A-110 **EAST ELEVATION**
SCALE: 1/32" = 1'-0"

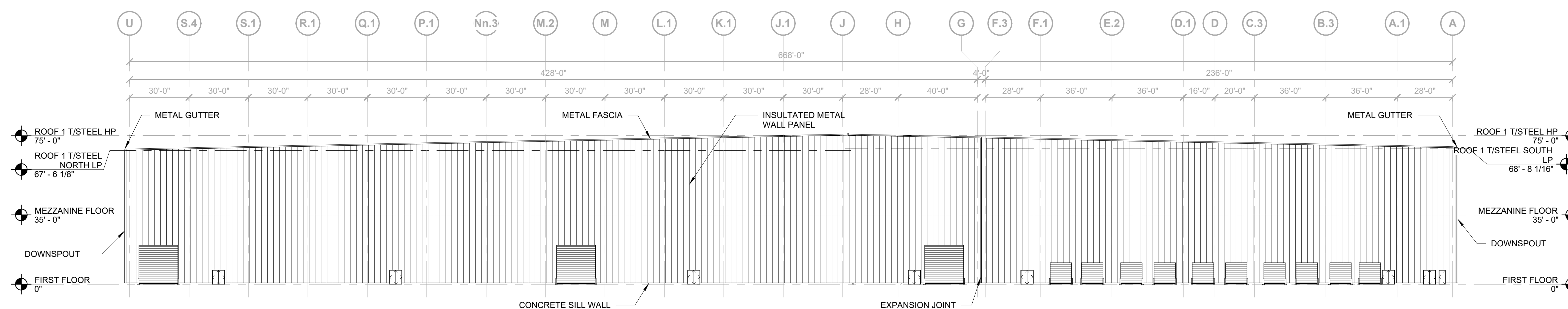

C3
A-110 **WEST ELEVATION**
SCALE: 1/32" = 1'-0"

04-25-2023	SITE PLAN REVIEW
DATE	ISSUED FOR

A/E TEAM INFORMATION	
IN CHARGE:	J. HEIDT
DRAWN BY:	P. KOHLER
DESIGNED BY:	A. GARZA
CHECKED BY:	J. BREAUULT
APPROVED BY:	J. HEIDT
A/E PROJECT NUMBER: 021-01658-00	
SHEET TITLE	
EXTERIOR ELEVATIONS - EAST & WEST	
SHEET NUMBER	BATT-001

[illegible]

TEAM INFORMATION	
CHARGE:	J. HEIDT
OWN BY:	K. SONIGRA
SIGNED BY:	C. MOHANATHAN
CHECKED BY:	W. BROOKS
APPROVED BY:	J. HEIDT
PROJECT NUMBER: 022-01220-00	
NET TITLE	
ELECTRICAL SITE DETAILS	
NET NUMBER	BATT-001
ES501	

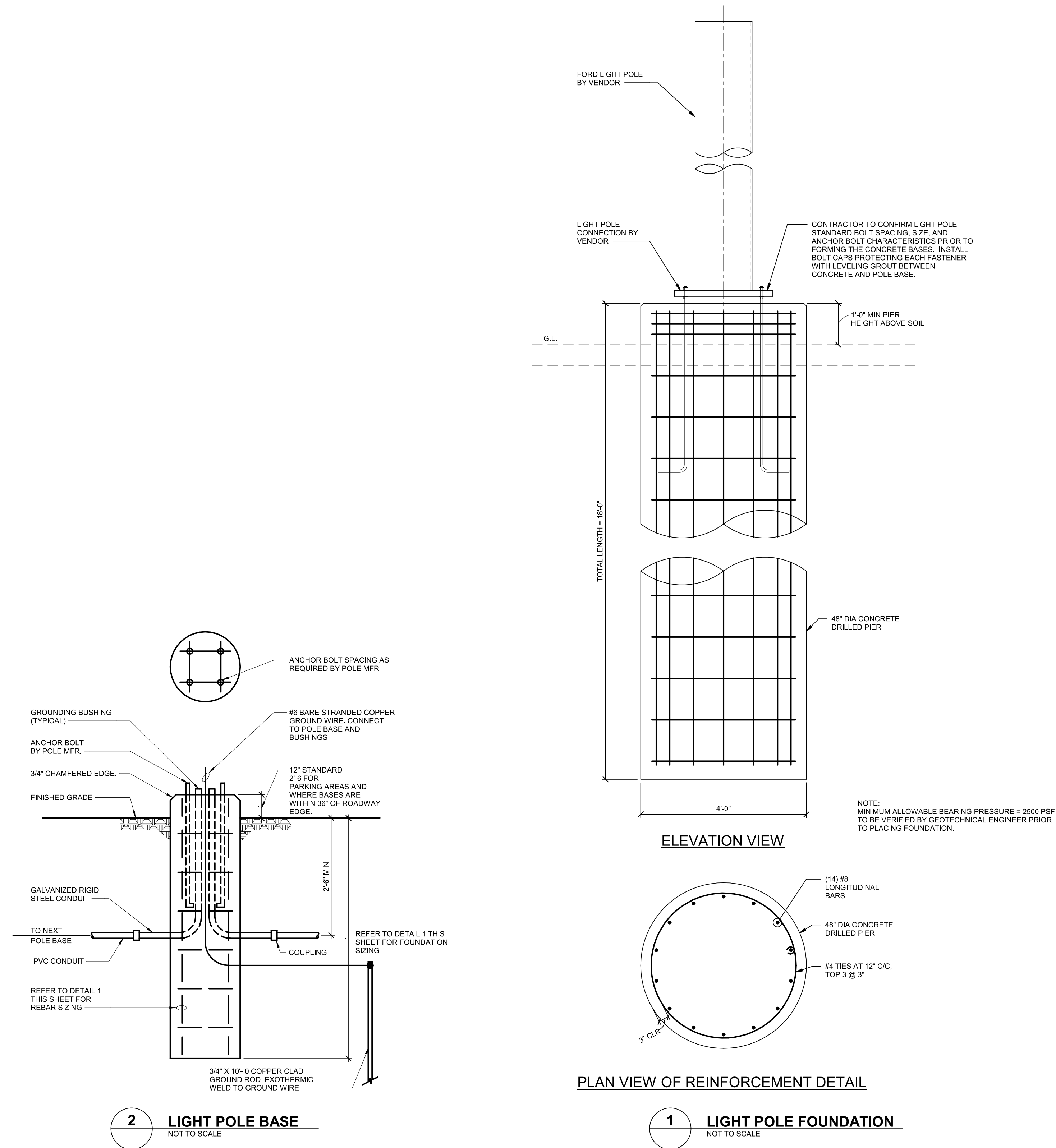

RSHALL	CALHOUN	MI
D LAND DOCUMENT PROJECT NUMBER:		BATT-001

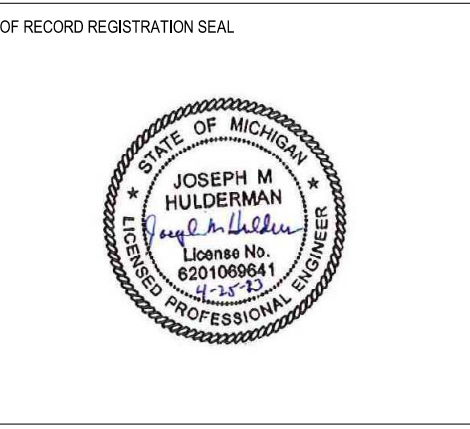
[illegible]

TEAM INFORMATION	
CHARGE:	J. HEIDT
OWN BY:	K. SONIGRA
DESIGNED BY:	C. MOHANATHAN
CHECKED BY:	W. BROOKS
APPROVED BY:	J. HEIDT
PROJECT NUMBER:	022-01220-00
SET TITLE	
ELECTRICAL SITE DETAILS	
SET NUMBER	BATT-001
ES503	

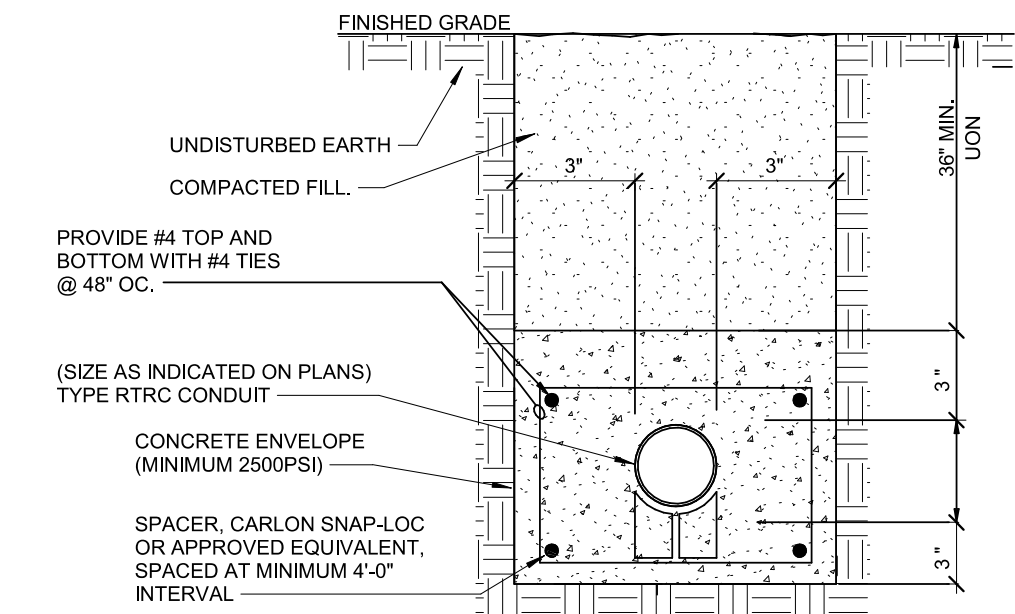

- NOTES:
1. PROVIDE THIS INSTALLATION TYPE AT ROADWAYS
 2. ENCASEMENT TO EXTEND 10'-0" BEYOND EDGE OF ROADWAY PAVEMENT.
 3. ELECTRICAL DUCT BANK RUNS TO BE MARKED WITH BELOW GRADE MARKER BALLS LOCATED ALONG UTILITY RUNS PER CIVIL SPECIFICATION.

1 **1x1 CONCRETE ENCASED DUCT BANK**
NOT TO SCALE

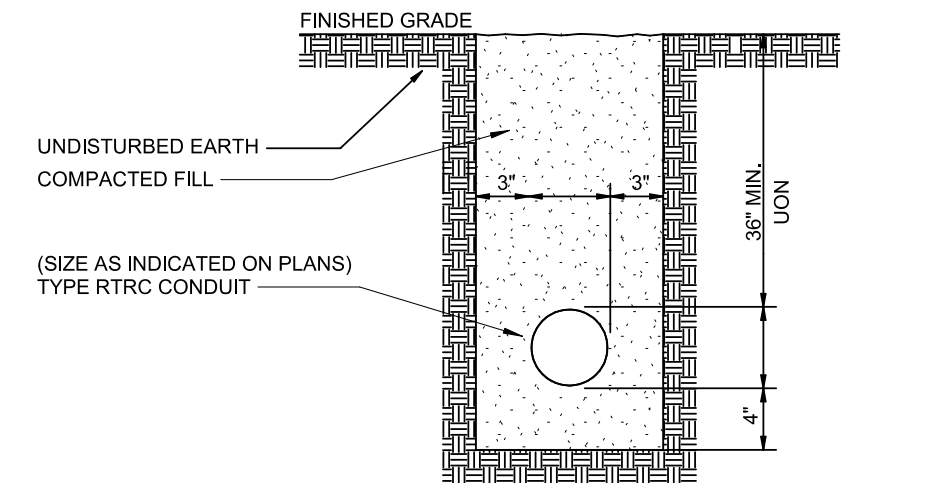

- NOTES:
1. PROVIDE SAND BED AT BOTTOM OF TRENCH, MINIMUM 3" DEPTH.
 2. ELECTRICAL DUCT BANK RUNS TO BE MARKED WITH BELOW GRADE MARKER BALLS LOCATED ALONG UTILITY RUNS PER CIVIL SPECIFICATION.

2 **1x1 DIRECT BURY DUCT BANK**
NOT TO SCALE

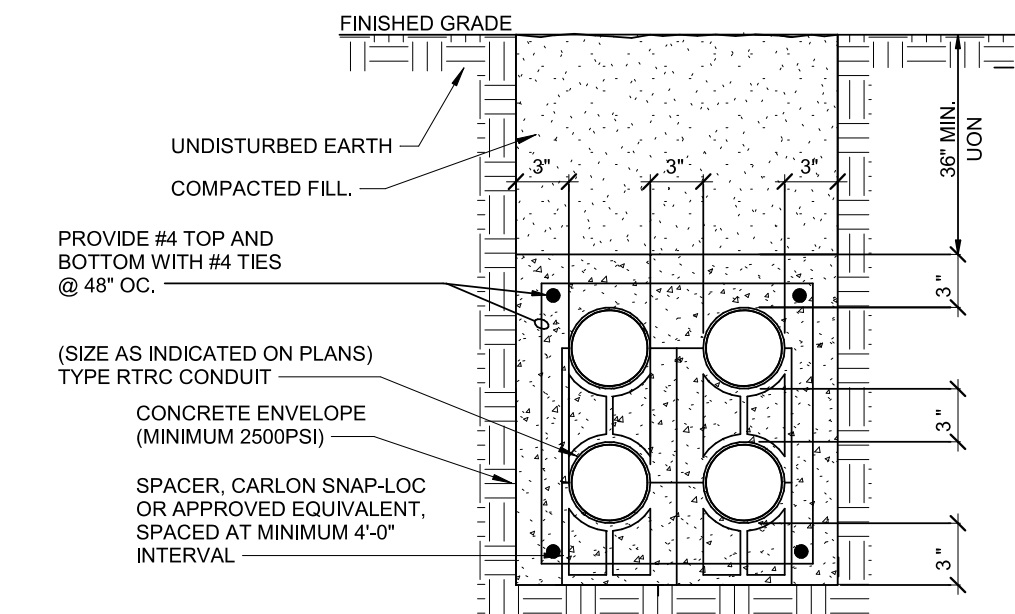

- NOTES:
1. PROVIDE THIS INSTALLATION TYPE AT ROADWAYS
 2. ENCASEMENT TO EXTEND 10'-0" BEYOND EDGE OF ROADWAY PAVEMENT.
 3. ELECTRICAL DUCT BANK RUNS TO BE MARKED WITH BELOW GRADE MARKER BALLS LOCATED ALONG UTILITY RUNS PER CIVIL SPECIFICATION.

3 2x2 CONCRETE ENCASED DUCT BANK
NOT TO SCALE

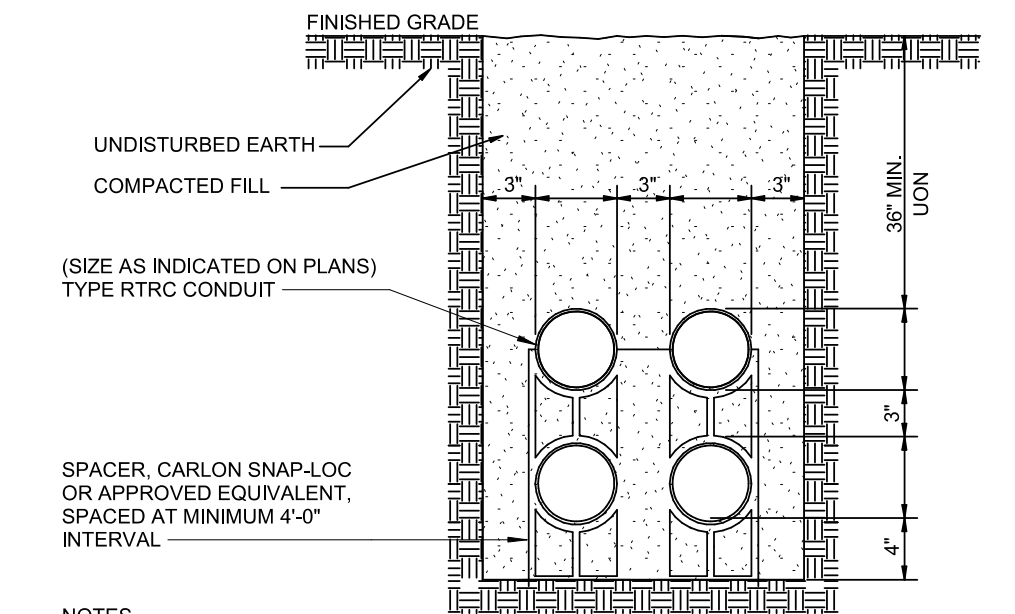

- NOTES.
1. PROVIDE SAND BED AT BOTTOM OF TRENCH, MINIMUM 3" DEPTH.
 2. ELECTRICAL DUCT BANK RUNS TO BE MARKED WITH BELOW GRADE MARKER BALLS LOCATED ALONG UTILITY RUNS PER CIVIL SPECIFICATION.

4 **2x2 DIRECT BURY DUCT BANK**
NOT TO SCALE

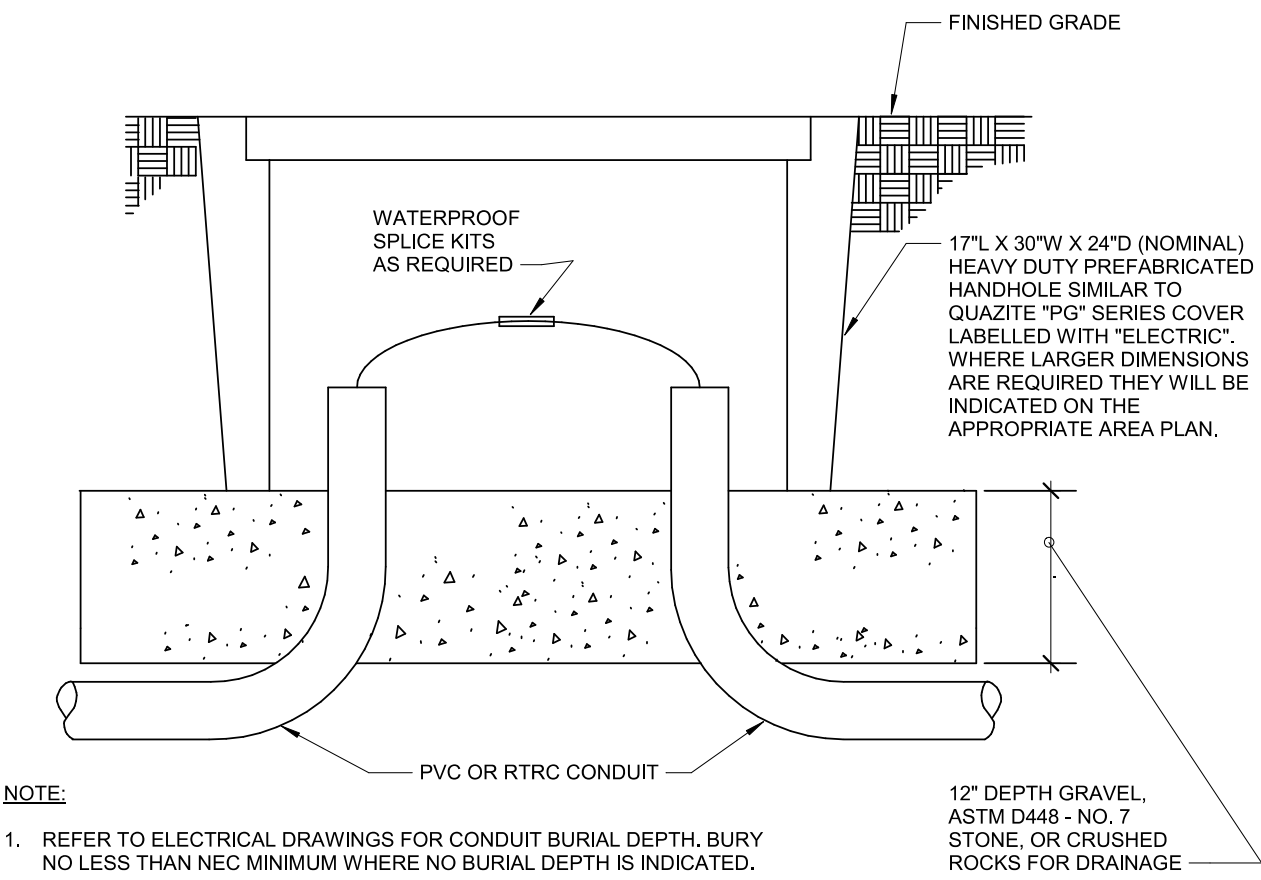

- NOTE:**
1. REFER TO ELECTRICAL DRAWINGS FOR CONDUIT BURIAL DEPTH. BURY NO LESS THAN NEC MINIMUM WHERE NO BURIAL DEPTH IS INDICATED.
 2. PROVIDE TRAFFIC RATED HANDHOLES AND COVERS IN AREAS SUBJECT TO VEHICULAR TRAFFIC.

5 **TYPICAL HANDHOLE**
NOT TO SCALE